

MİMARİ KATALOG ARCHITECTURAL CATALOGUE

Alüminyum Kapı Pencere ve Giydirme Cephe Sistemleri
Aluminium Window Doors and Facade Systems

RESCARA

RO73



MİMARİ KATALOG

ARCHITECTURAL CATALOGUE

Alüminyum Kapı Pencere ve Giydirme Cephe Sistemleri
Aluminium Window Doors and Facade Systems



Rescara Sistem Detayları
Rescara System Details

RO73

PROFİLLER

PROFILES

01

02

03

04

05

06

07



08

09

10

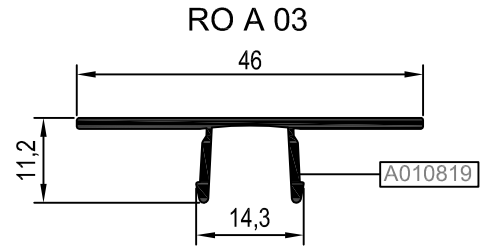
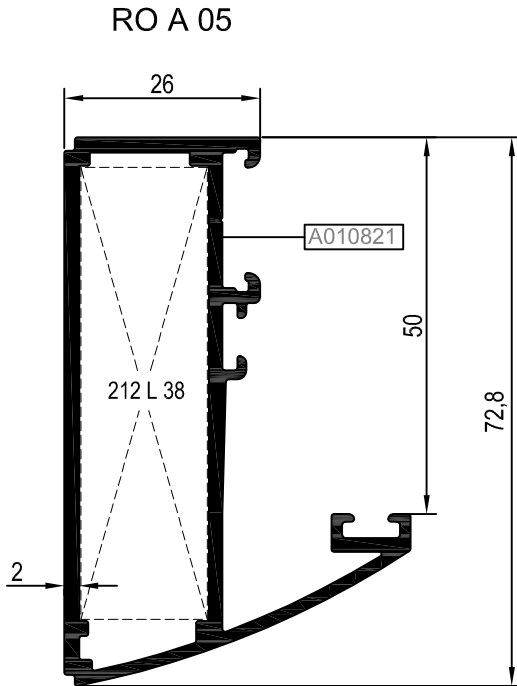
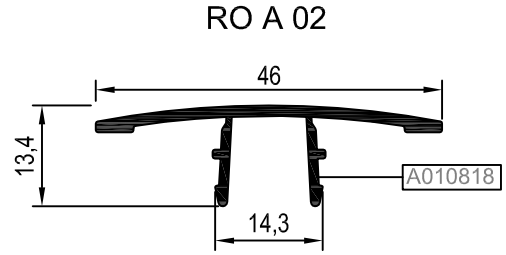
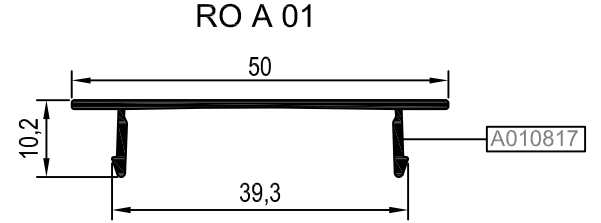
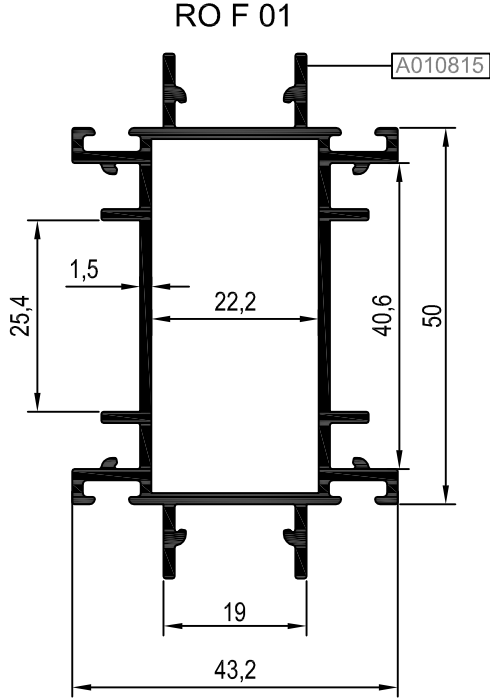
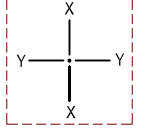
KOD / CODE	AĞIRLIK (kg/m) / WEIGHT	Jxx cm ⁴	Jyy cm ⁴	L m
RO F 01	1,110	6,599	18,194	6
RO A 01	0,208	---	---	6
RO A 02	0,271	---	---	6
RO A 03	0,234	---	---	6
RO A 05	1,214	---	---	6



Nr	 L m	KEŞİM ÖLÇÜSÜ CUTTING SIZE	 AKS. KODU ACS. CODE	
RO A 05	A010821	25 L 38 (A002074)	59,8 mm	212 L 38

ETEK VE ADAPTÖR PROFİLLERİ
KICK PLATE AND ADAPTER PROFILES

R073

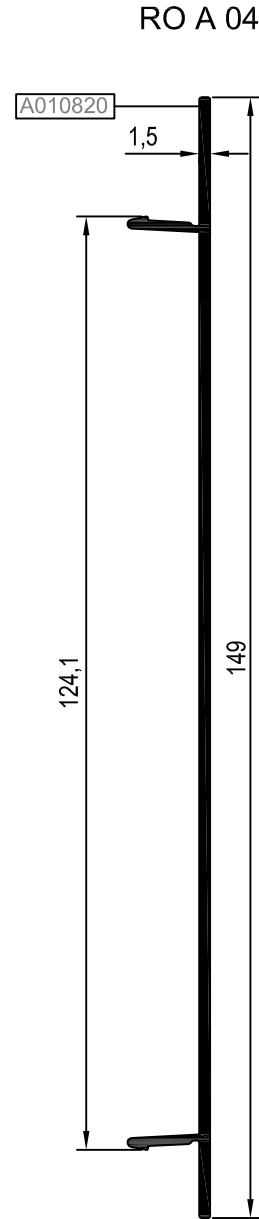
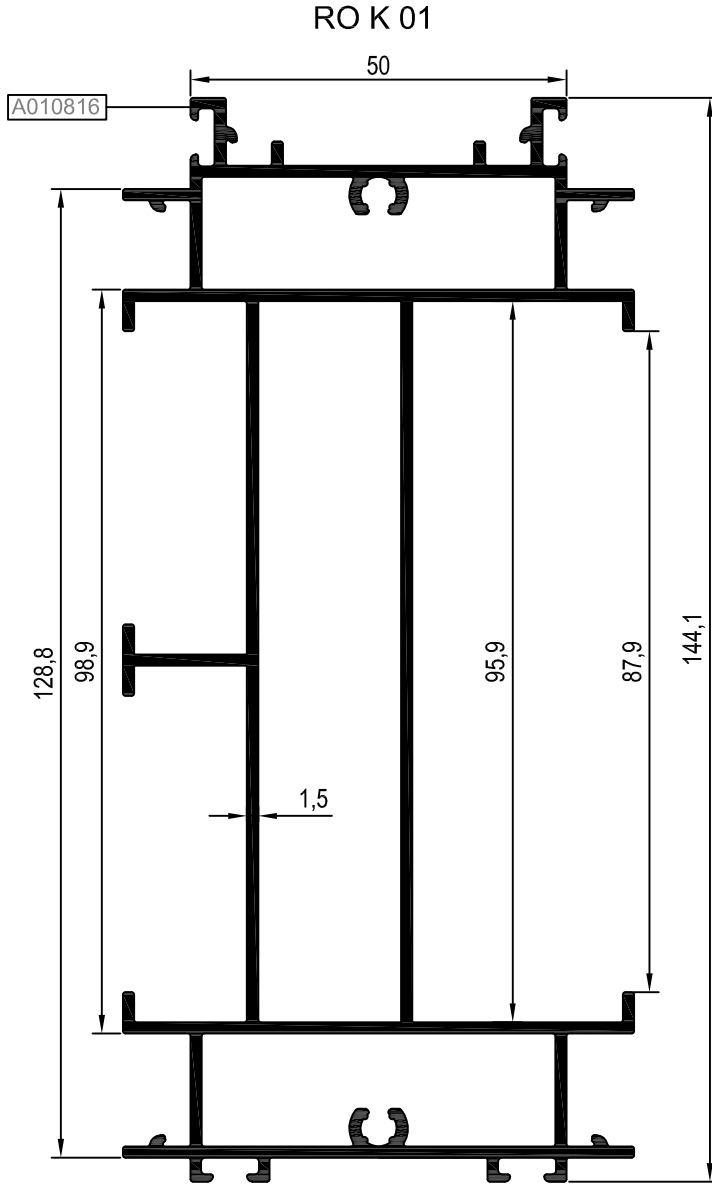
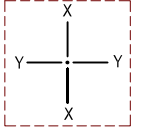

KOD / CODE	AĞIRLIK (kg/m) / WEIGHT	Jxx cm ⁴	Jyy cm ⁴	L m
RO K 01	2,637	---	---	6
RO A 04	0,647	---	---	6



TAKOZLAR (CLEATS)

PROFİL KODU (PROFILE CODE)	25 L 38			
FABRİKA KODU (FACTORY CODE)	A002074			
AĞIRLIK (WEIGHT)	4,854 kg/m			
ÇİZİM (DRAWING)				

KÖŞE TAKOZLARI (CORNER CLEATS)

Nr			KEŞİM ÖLÇÜSÜ CUTTING SIZE	 AKS. KODU ACS. CODE
RO A 05	A010821	25 L 38 (A002074)	59,8 mm	212 L 38

MİMARİ KATALOG

ARCHITECTURAL CATALOGUE

Alüminyum Kapı Pencere ve Giydirme Cephe Sistemleri
Aluminium Window Doors and Facade Systems



Rescara Sistem Detayları
Rescara System Details

RO73

DETAYLAR

DETAILS

01

02

03

04

05

06

07

08

09

10

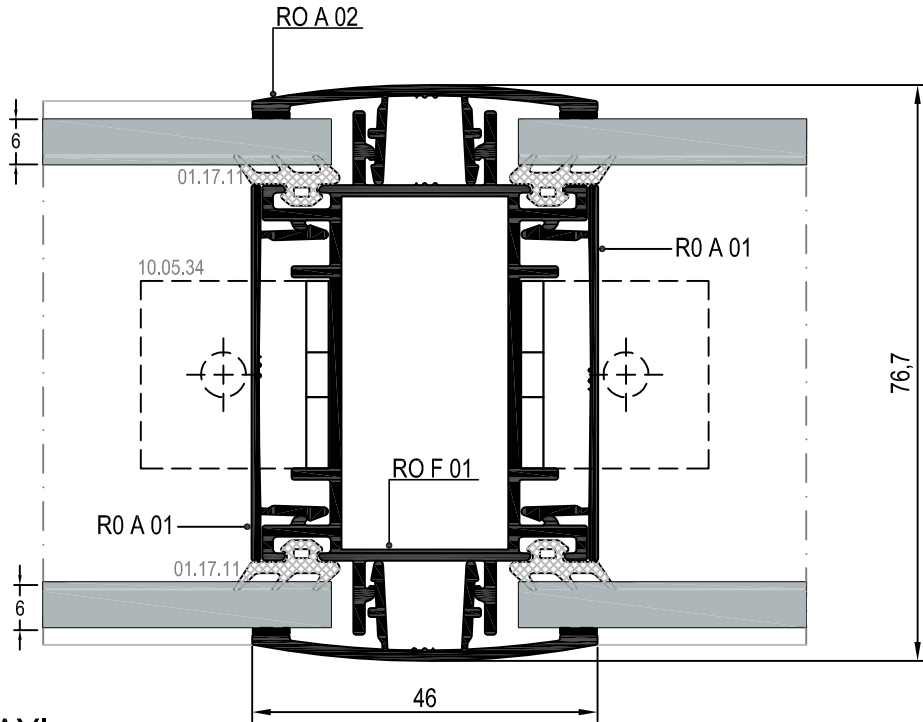
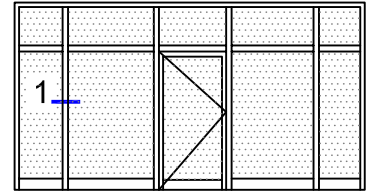

① DETAYI
DETAIL

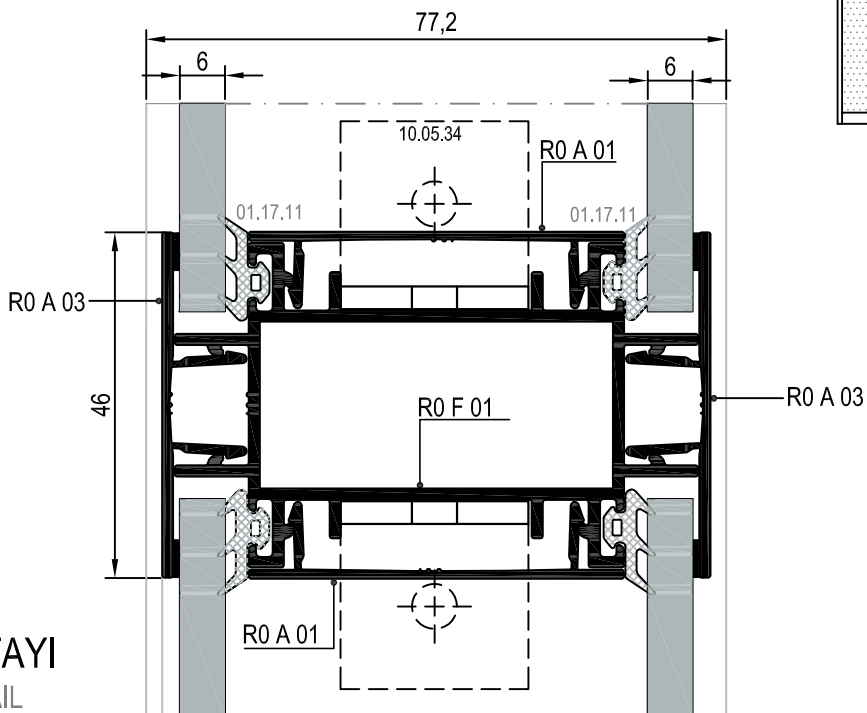
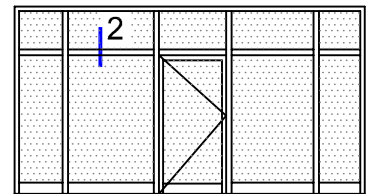

② DETAYI
DETAIL

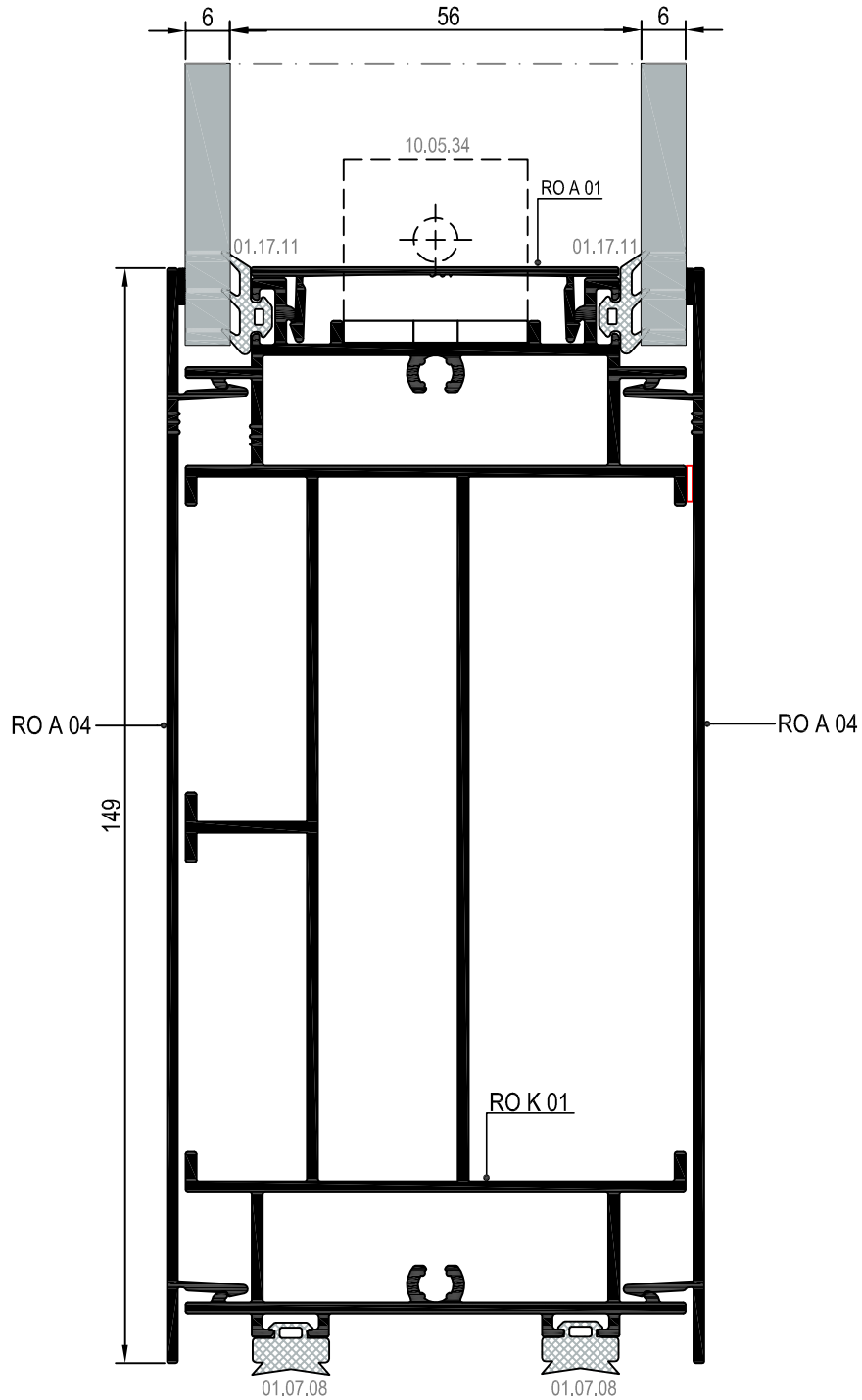
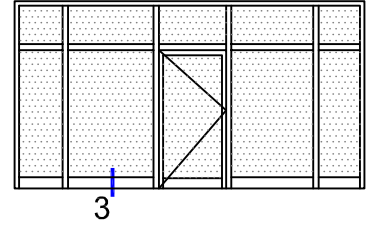

③ DETAYI
DETAIL

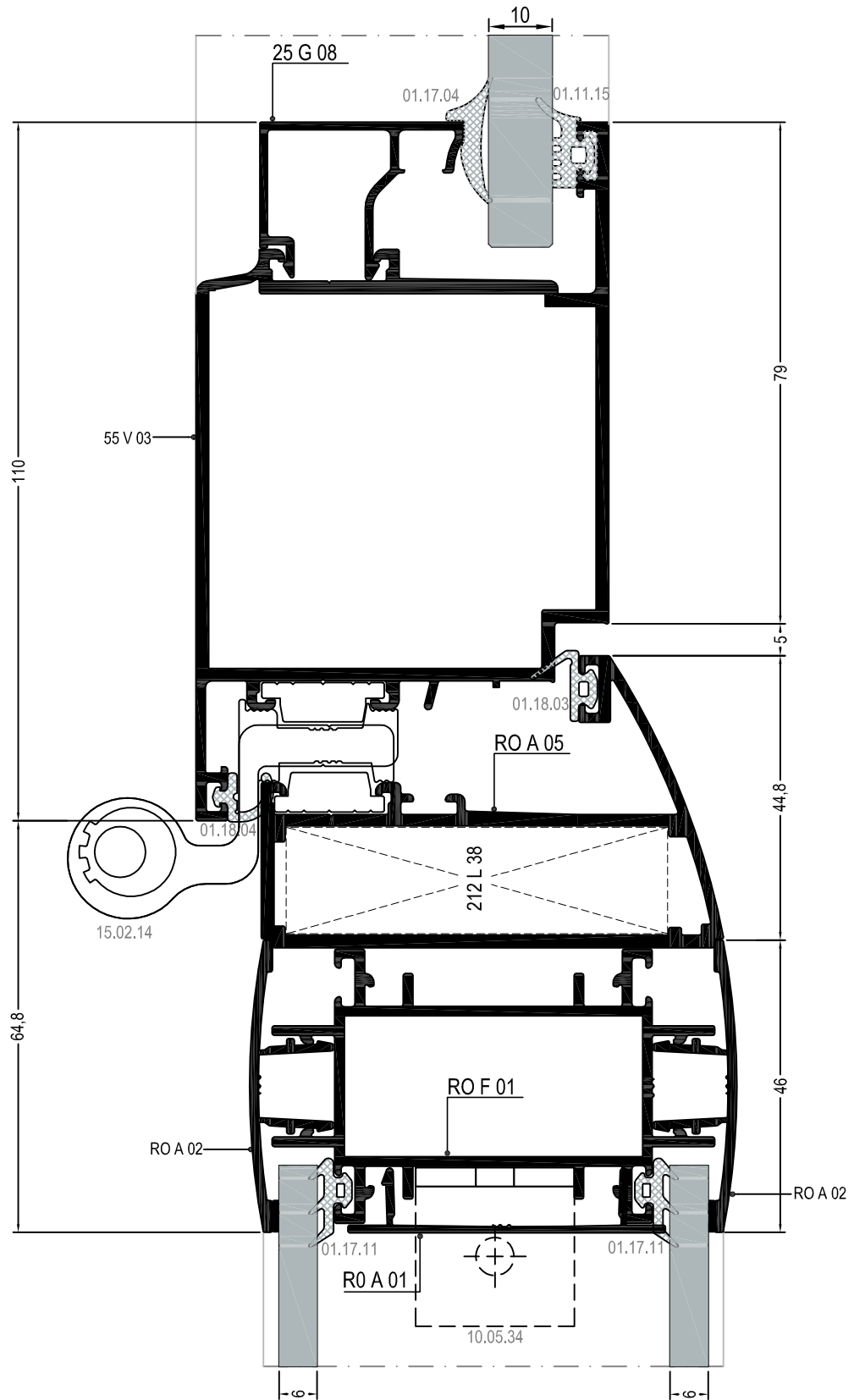
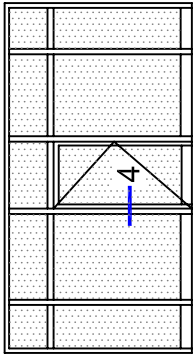

④ DETAYI
DETAIL

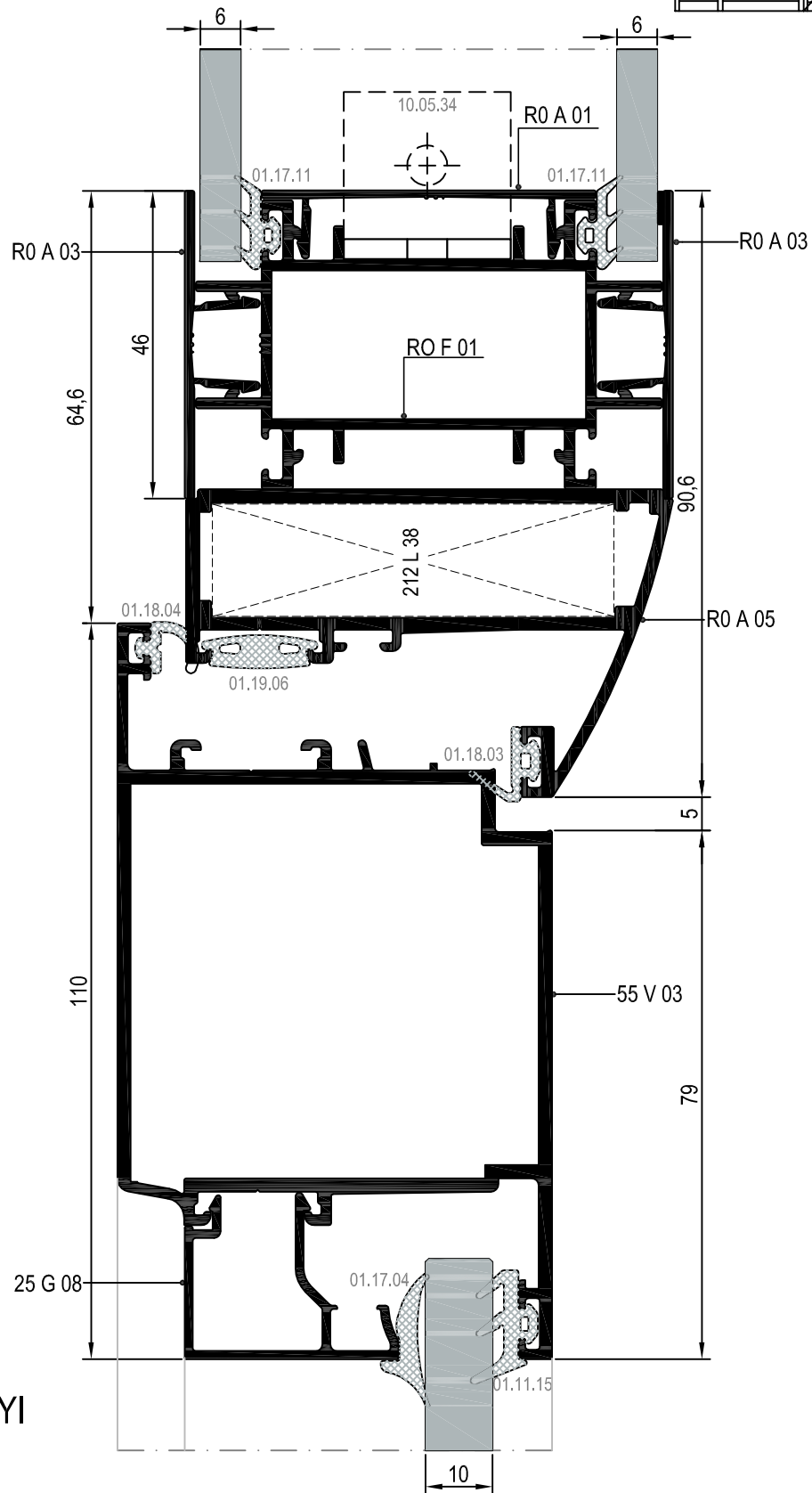
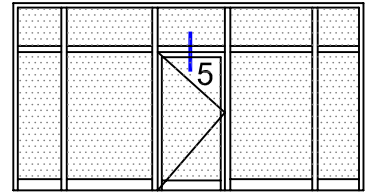

⑤ DETAYI
DETAIL

MİMARİ KATALOG

ARCHITECTURAL CATALOGUE

Alüminyum Kapı Pencere ve Giydirme Cephe Sistemleri
Aluminium Window Doors and Facade Systems



Rescara Sistem Detayları
Rescara System Details

RO73

AKSESUARLAR

ACCESSORIES

01

02

03

04

05









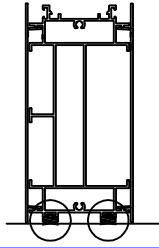

06

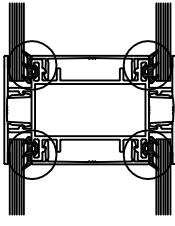
07

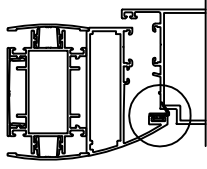
08

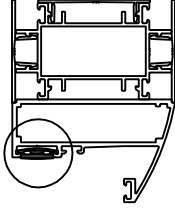
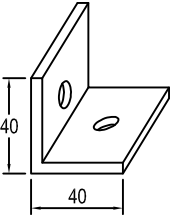
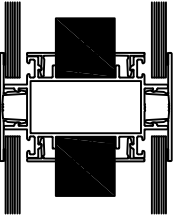
09

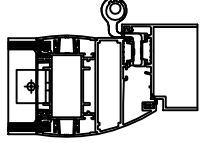
10

	<p>01.07.08</p> <p>ETEK ALTI FITİLİ KICK PLATE GASKET</p> <p>Malzeme / Material : EPDM Ağırlık / Weight : 70 gr/m Paket / Package: 214m / 15 kg</p>				
	<p>01.17.11</p> <p>CAM FITİLİ GLAZING GASKET</p> <p>Malzeme / Material : EPDM Ağırlık / Weight : 235 gr/m Paket / Package: 63,8 m / 15 kg</p>				
	<p>01.18.03</p> <p>DIŞ BİNİ FITİLİ OUTSIDE ACOUSTICAL GASKET</p> <p>Malzeme / Material : EPDM Ağırlık / Weight : 41 gr/m Paket / Package: 365 m / 15 kg</p>				
	<p>01.19.06</p> <p>ÇITA KANAL FITİLİ ADAPTER GASKET</p> <p>Malzeme / Material : EPDM Ağırlık / Weight : 80 gr/m Paket / Package: 185 m / 15 kg</p>				
	<p>10.05.34</p> <p>BAĞLANTI PARÇASI CONNECTION PIECE ALÜMİNYUM 25 mm</p>				
	<p>15.02.09</p> <p>YERLİ KAPI MENTEŞESİ LOCAL HINGE FOR DOORS Renk: Siyah-Beyaz-Gri-Eloksal Color: Black-White-Grey-Anodised 85kg için 3adet kullanılmaktadır./Should be used 3 for 85kg. Max.kanat ölçüsü 900x2200./Max.vent dimension 900x2200</p>				
	<p>15.02.14</p> <p>GIESSE KAPI MENTEŞESİ GIESSE HINGE FOR DOORS Renk: Siyah-Beyaz-Gri-Eloksal Color: Black-White-Grey-Anodised 100kg için 2adet, 120kg için 3adet kullanılmaktadır./Should be used 2for 100kg, 3for 120kg. EN 1935</p>	