

# NICE

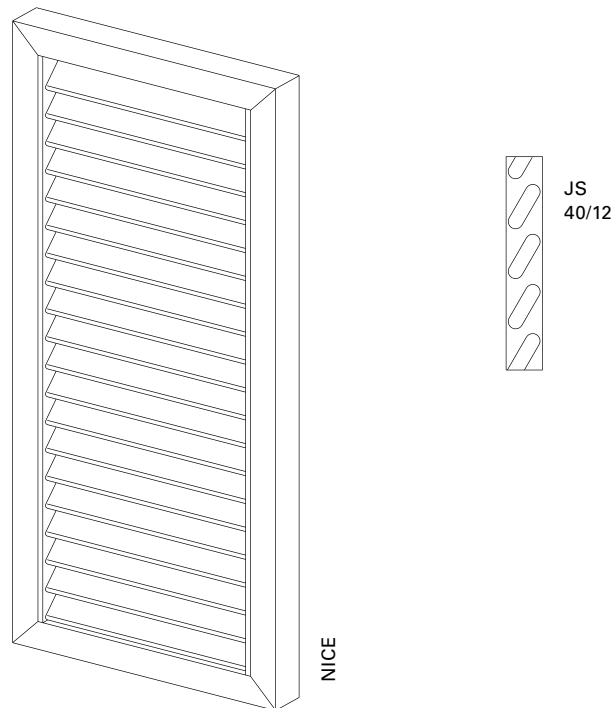

---

<b>Surface</b>	Fine structure matt (standard), silk gloss, matt Powder-coated 200°C before assembly
<b>Colours</b>	RAL Classic, RAL Design, NCS, VSR
<b>Finishes</b>	Wood, stone, rust
<b>Pretreatment</b>	Ocean Line Plus possible
<b>Notes</b>	Electric drive and finish are not possible in combination with special shapes Drain holes at bottom of frame Fittings can only be integrated to a limited extent Slats are exchangeable

Slat profile

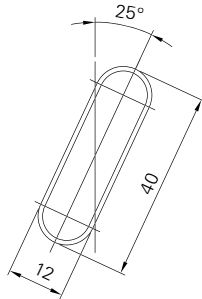

JS

Frame profile

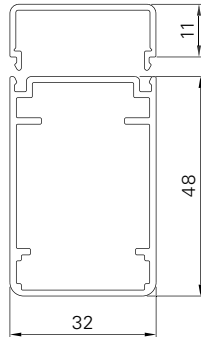

R48

Horizontal cross-panel/  
Vertical cross-panel

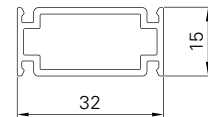

L15

<b>Min./Max. dimensions</b>	Width: 280 to 800 mm Height: 800 to 2500 mm
<b>Min./max. infeed</b>	33,0–36,7 mm
<b>Inclination angle</b>	25°
<b>Weight</b>	Approx. 6 kg/m <sup>2</sup>
<b>Frame profile</b>	48 × 32 mm extruded aluminium hollow chamber profile
<b>Slat profile</b>	40 × 12 mm extruded aluminium hollow chamber profile
<b>Slat carrier profile</b>	32 × 11 mm extruded aluminium
<b>Stop bead</b>	Supplied loose, black or white rubber (depending on sash colour)

**Corner connections** Aluminium bracket, glued-in and additionally secured by plastic pins

**Options** Notching | Electric drive | Vertical cross-panel | Rabbet bead | Horizontal cross-panel | Half-round arch (mounted) | Pre-installation | Basic frame | Catch | Segmental arch, hollow (mounted) | Frames | Segmental arch, solid (mounted) | Special shapes (arched frame profile)