

Much  
more  
than a  
window.

**OTIIMA**

[www.muchmorethanawindow.com](http://www.muchmorethanawindow.com) | [info@muchmorethanawindow.com](mailto:info@muchmorethanawindow.com)

accuracy  
comfort  
customization  
innovation  
integration  
**limitless**  
minimal  
revolution  
security  
technology  
transparency



**OTIIMA | Much more than a window** is an international trademark associated with three major areas of activity: metal works, frame works and art works. We collaborate closely with the professionals from the conception stage to development, production, assembly and installation, providing total support to achieve their expectations.

Our strategy is established by combining research, cutting-edge technology and industry, thus raising the minimal frame system market worldwide, together with a worldwide commercial network.

**OTIIMA | Much more than a window** is an award-winning brand, recognized by its experience in the field, an enterprising attitude and a powerful vision of the future. All of our tailored solutions meet the highest requirements when it comes to design, comfort and security.

**Much  
more  
than a  
window.**

**OTIIMA**

8 years ago, we had a dream. To create a brand of minimal frame systems and solutions, that could be much more than windows. That brand is OTIIMA. OTIIMA is the trademark for minimal frame systems and solutions, being MUCH MORE THAN A WINDOW the added corporate value for every system or solution presented by OTIIMA.

**OTIIMA | Much more than a window** developed 4 standard and complementary main systems:

**OTIIMA CLASSIC** is the first minimal frame system that OTIIMA presented to the market and where everything started. With only 20mm thick vertical interlocks, the CLASSIC system allows large glazed surfaces and offers high-class water tightness, air permeability, wind-load resistance and thermal insulation features.

**OTIIMA PLUS** is the second minimal frame system, that took advantage from the knowledge and experience acquired during the development stage of OTIIMA

**CLASSIC.** The PLUS system upgraded the vertical interlock's design and structure, achieving a highlighted and exclusive position in the market of minimal frame systems, concerning:

- Air and water tightness (best performance in the market)
- Invisible and incorporated lock-handle,
- Head and still frames perfectly integrated with the construction materials around the four sides of the window.

The OTIIMA PLUS system was distinguished and awarded with the Red Dot Design 2017 and the German Design Award 2019.

**OTIIMA FUSION**, the third minimal frame system created by OTIIMA, is completely merged within the architectural and finishing materials, offering hidden head, sill and jamb frames, with no visible bearings. The window totally merges with the building, becoming one. Available in two series: Fusion 1.0 e Fusion 2.0. Worldwide awarded with Innovation Award 2017 and German Design Award 2019.



## ABOUT OTIIMA

**OTIIMA FLEX**, the fourth minimal frame system developed by OTIIMA, represents a system that can be customized with a decorative sub-frame in different sizes and expressions, enhancing the window and making it an essential element of the architectural composition.

The Portuguese architect Carvalho de Araújo is the author of the OTIIMA FLEX system.

Complementary systems like **DRAIN**, **LESSFRAME** and **LARGLASS** offer other personalized solutions like automations, integration of artificial intelligence, modular and integrated systems. Also special materials like fiberglass, resin and acrylic may be applied.

This is **OTIIMA | Much more than a window's** world. A range of systems and solutions that are much more than a window. A window towards the future that could be drawn for you.

- 
- 
- 

Much more than a window.



Much  
more  
than a  
window.

**OTIIMA**

**OTIIMA | Much more than a window** is the perfect solution for your project, when the combination of quality, high technology and aesthetics are the main reasons for your choice.

By using **self-supporting glasses**, our systems push back architectural limits and offer the possibility to use glazed surfaces up to 36m2 per pane.

From the floor to the ceiling, a 20mm vertical reinforced profile provides a minimal appearance, merging indoor and outdoor into one, meeting the highest quality standards. The slim and elegant handle provides a streamlined appearance, that when combined with a special rolling system, guarantees easy hand opening and maintenance of the panes.

Optionally, for an even higher level of comfort, the system can be motorized and remotely controlled.

**Exceptional watertightness performances**, air permeability and wind resistance.

Exceptional binding polyamides and high energy performance glasses assure a top thermal and acoustic efficiency and comfort feeling. Available in single, double and triple glass, OTIIMA systems also provides a perfect flushed and merged minimal solution. In combination with a safe toughened glass, the **exclusive hidden lock and security system** assures the highest safety levels with a unique and elegant solution.

**OTIIMA | Much more than a window** offers a full and complete range of solutions according to the needs of each architectural project.

A multidisciplinary and technical team, with specific knowledge on each market, will be in charge of each project, accompanying and providing technical assistance, assembly and after-sales services.



# TECHNICAL DETAILS

**OTIIMA | Much more than a window** offer a **lifetime guarantee**, which reflects our confidence on the high quality of the design, engineering, production, durability and performance of our products.

Our windows and accessories are manufactured in accordance with the most demanding European quality and safety standards and are free from any defects at the time of the installation. This warranty applies to all continents where OTIIMA's products are sold directly by us or by any authorized partner.

### TERMS AND CONDITIONS

We offer a lifetime warranty, subject to the terms of the normal warranty. Our warranty covers all manufacturing defects.

### LIFETIME WARRANTY

ALIANZ | APOLICE 203688590/0

advantages and lifetime warranty



Much more than a window.

**OTIIMA**

Much  
more  
than a  
window.

# OTIIMA

From the floor to the ceiling, a 20 mm vertical reinforced profile provides a minimal appearance merging indoor and outdoor into one.

**OTIIMA | Much more than a window** is globally recognized for its minimal windows, and all its profiles are prepared for a superior thermal, acoustical, water and air permeability performances.

Achieve an excellent continuity between the inside and the outside.

## HIGH DIMENSION GLASSES

By using self-supporting glasses, OTIIMA systems pushes back architectural boundaries and offers the possibility to use glazed surfaces up to 36 Sq m.

## ARCHITECTURAL INTEGRATION

Perimeter profiles with the same size and configuration as the sliding series profiles.  
Merge tilt & turn and sliding windows in the same building, without noticing any visual difference between the window systems.

large dimension glasses, slim profiles



\*  
Private house | system OTIIMA PLUS



# PERFECT INTEGRATION | MAINTENANCE FREE

- 
- 
- 

windows and building merged into one

Achieve a perfect continuity between the interior and the exterior, without any architectural barriers.

When the combination of quality, high technology and aesthetics are the main reasons for your choice, **OTIIMA | Much more than a window** is the perfect solution.

- 
- 
- 

## SLIM PROFILES, EASY OPENING

OTIIMA's invisible and elegant handle provides a streamlined appearance, which combined with the special OTIIMA rolling system, guarantees easy hand opening and maintenance of the panels.

## PROFILES PERFECTLY LEVELLED WITH THE FLOOR

All OTIIMA's window profiles are designed to merge perfectly with the floor, avoiding any gap or unevenness.

Moreover, OTIIMA FUSION is a system fully integrated into the finishing materials, as shown on the side picture. The window is merged with the building, becoming a whole.

## MAINTENANCE FREE SOLUTION

OTIIMA FUSION 2.0 besides being fully integrated into the finishing materials, is maintenance free. The reduced visible slot is designed with only 11mm wide, and it is protected with plush wire to inhibit leaves or other natural dirt to accumulate on its cavity. As so, it is a system that requires no maintenance.



\*

Private house | system OTIIMA FUSION

Much more than a window.

# OTIIMA

- 
- 
- 

## hidden high security lock | electromagnetic locks

All OTIIMA's windows are equipped with an exclusive invisible lock, perfectly merged into the handle.

Experience the most minimal lock, with a high level of security performance and intuitive handling

- 
- 

### ONE-HAND LOCK CONTROL

Exclusive invisible lock, perfectly merged into the window's profile. Open any OTIIMA's window by gently pressing its handle.

Effortless and intuitive opening system, regardless of the window's dimensions.

### TWO-HAND LOCK CONTROL

With new generation hidden security locks, it is possible to apply a security system where the window opening only occurs if the operator uses both hands.

This safety system is especially effective in preventing use by children.

OTIIMA's windows are equipped with highly efficient security solutions.

In addition to the traditional manual locking systems, automatic electromagnetic locks are also available. If a higher level of security is necessary, the window can be equipped with alarm cells.

All OTIIMA's windows are standardly equipped with a multiple point locking system.

- 
- 

### ELECTROMAGNETIC LOCK

To manage access control or for optimal security, a hidden electromagnetical lock can be included into windows.

### SAFETY SENSOR (HANDLE POSITION)

With a safety band installed on the whole extension of the handle, the user's safety is 100% assured.

### ALARM

All OTIIMA's windows allow a perfect integration of alarm cells or other domotic features.





remote control | domotics

Experience the possibility to operate your window automation with piezo switches, remote control or with a global **home automation system**.

.  
. .  
.

## DOMOTICS PROVIDES NEW UNLIMITED POSSIBILITIES

. When you press the start button, all windows close and shutters descend.

. There's no need to have a switch for each service (light, windows, curtain, shutter). All these commands can be gathered into only one switch

. Possibility to control your windows from every device, such as iPhone, iPad or others.

. If you switch on air conditioning, the windows automatically close

. If the wind increases, the windows automatically close

. If the weather forecast predicts rain, the windows automatically close

. If you want to go to the garden, when you open the windows, the shutters automatically open in order to let you pass

. If a window is still open after you switched on the alarm, it automatically closes

. If you want windows to be closed when you turn on the television, this can be done for you.



\*

OTIIMA INTELLIGENT remote control



Much more than a window.

OTIIMA

All OTIIMA's windows can be motorized, regardless of the window size or opening type.

OTIIMA's motorization system integrates an exclusive technology that enables easy shifting from automatic to manual opening by clutch disengagement.

Such system is highly useful if the automatism becomes inoperable due to a general failure of the energy supply or if the backup batteries get discharged.

Our motorized opening and closing systems replicate perfectly the manual movements, enabling soft closing "clicks" even when operating large-scale windows.

.  
.
   
.

**REMOTE CONTROL AND DOMOTICS**

Every automated window may be operated with piezo switches, remote control or with a global home automation system.

You may experience the possibility to control your windows from every device, such as iPhone or iPad. You may also set your automated windows to automatically close when the air conditioning is on, when the weather forecast predicts rain, or if the wind is raising.

Other features and options can be consulted in the motorization chapter.

effortless opening | domotics and remote control

.  
.
   
.



\* Private house | system OTIIMA PLUS



maximum acoustical and thermal comfort

All OTIIMA's windows are assembled with anti-injury glasses and 20 mm thick vertical profiles. Besides enabling large glazed surfaces, OTIIMA | Much more than a window offer excellent watertightness and air permeability performance levels, as well as wind-load resistance and great thermal insulation, that translates into a feeling of indoor comfort.



#### EXCEPTIONAL PERFORMANCES

Exceptional water tightness performances: Class E1050 (best reached in class in the market).

Air permeability: Class 4.

Wind resistance: Class C5.

Sound insulation: Up to  $R_w = 38$  dB.

#### SUPERIOR THERMAL BREAK TECHNOLOGY

Exceptional bonding polyamides and high energy performance glasses, assure a top thermal and acoustic efficiency and a warm comfort feeling. OTIIMA windows are available in single, double and triple glass.



\*

Private house | system OTIIMA CLASSIC

Much  
more  
than a  
window.

OTIIMA

— NAME  
ONE LIVING

— USED SYSTEM  
OTIIMA 38 PLUS

— WORK BY  
ECOSTEEL | OTIIMA PORTUGAL

— LOCATION  
PORTUGAL

— ARCHITECTURE  
FREDERICO VALSASSINA

— PHOTOGRAPHY  
BRUNO LANÇA

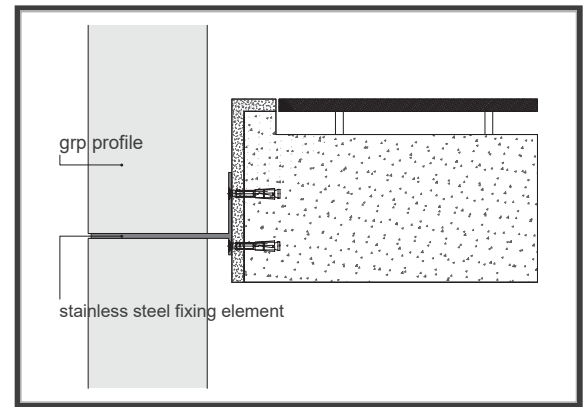

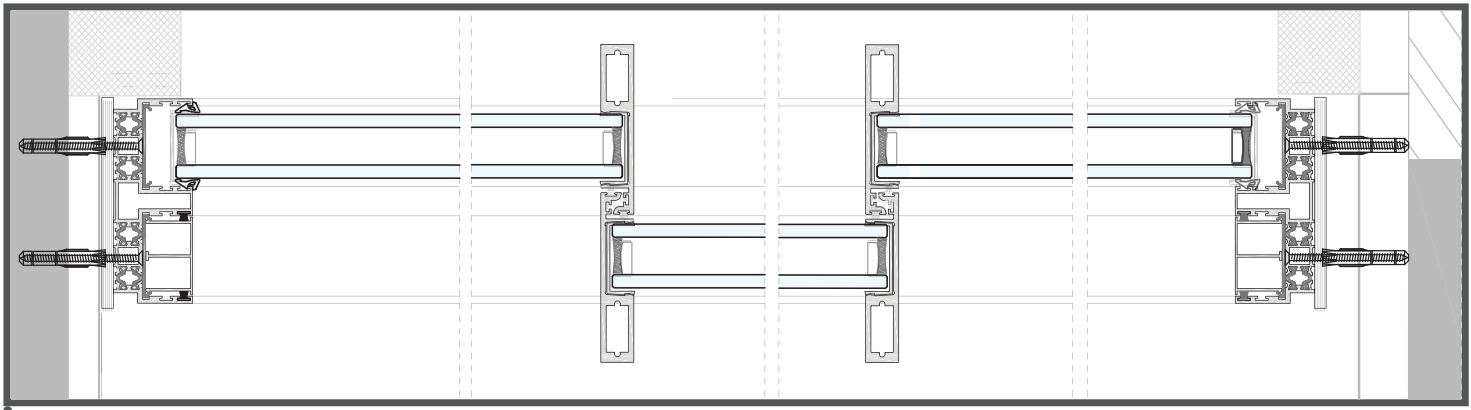

Much  
more  
than a  
window.

**OTIIMA**

— NAME  
PALMARES OCEAN LIVING & GOLF

— USED SYSTEM  
OTIIMA PIVOT DOOR

— WORK BY  
ECOSTEEL | OTIIMA PORTUGAL

— LOCATION  
PORTUGAL

— ARCHITECTURE  
RCR ARQUITECTES

— PHOTOGRAPHY  
KRONOS HOMES

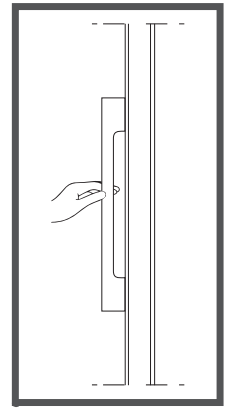



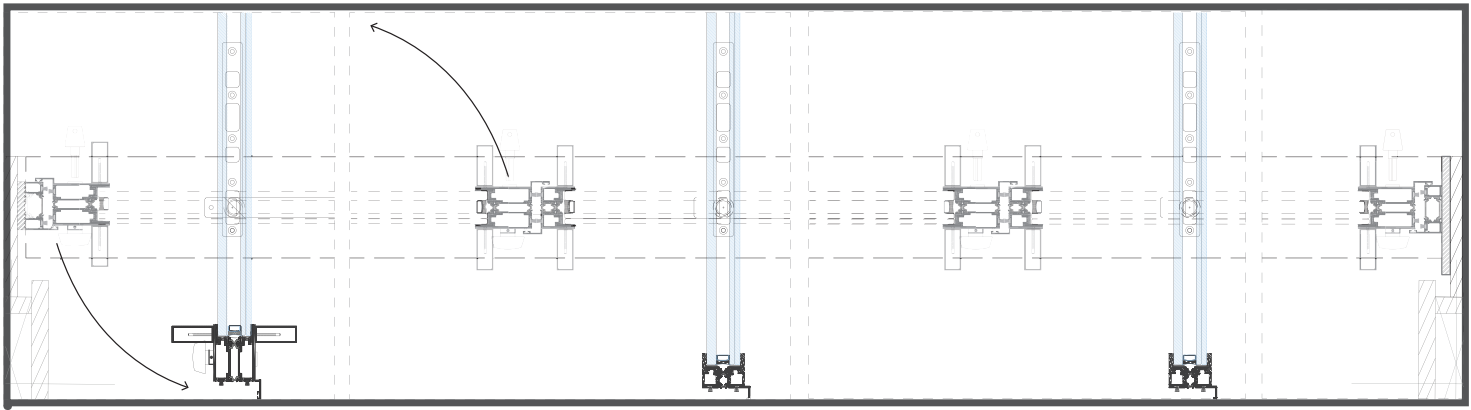

Much  
more  
than a  
window.

**OTIIMA**

— NAME  
RODEO DR HOUSE

— USED SYSTEM  
OTIIMA FUSION

— WORK BY  
OTIIMA USA

— LOCATION  
UNITED STATES OF AMERICA

— ARCHITECTURE  
STUDIO WILLIAM HEFNER

— PHOTOGRAPHY  
ADRIAN TEIMENS

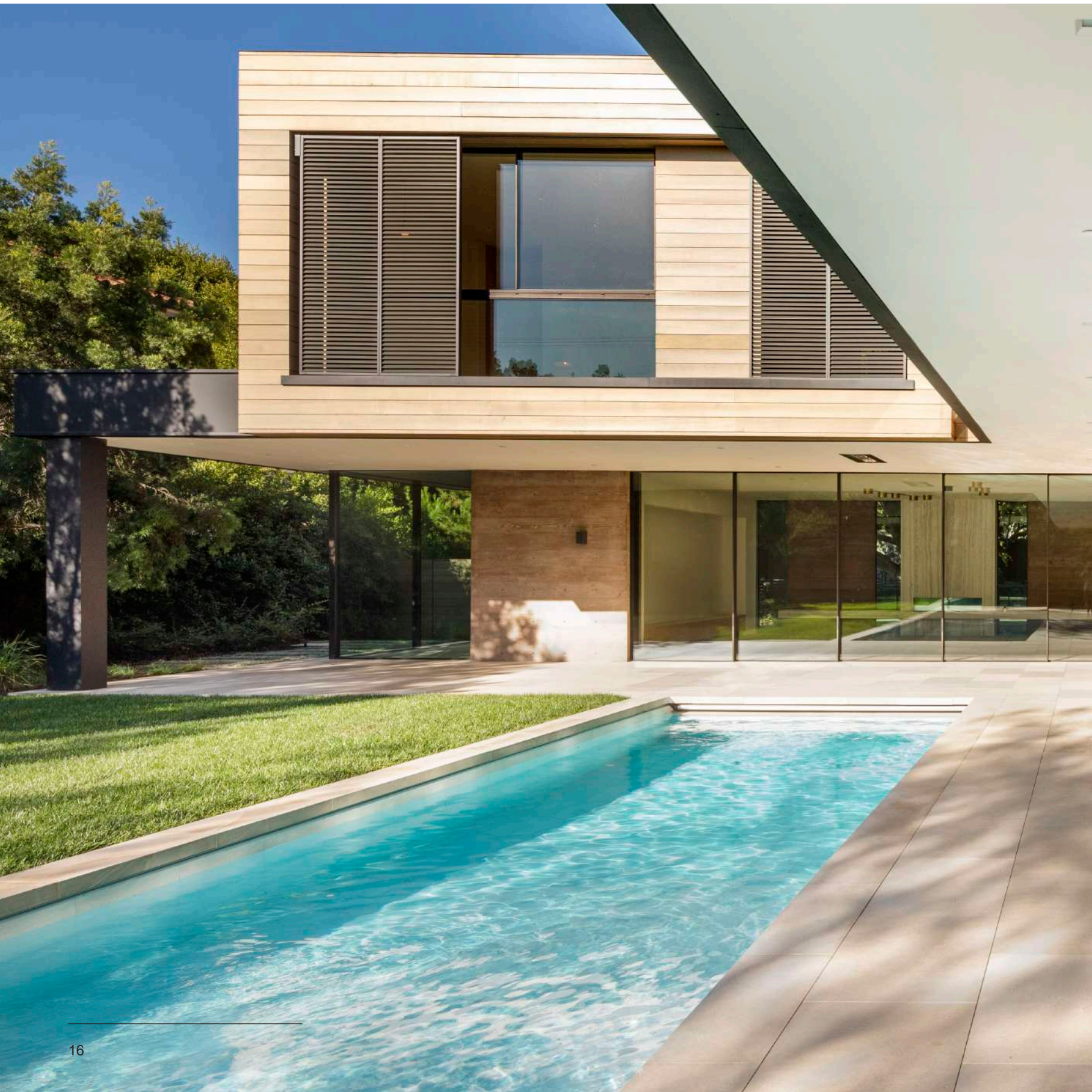



Much  
more  
than a  
window.

**OTIIMA**

— NAME  
1510 HOUSE

— USED SYSTEM  
OTIIMA PLUS

— WORK BY  
ALUMILUX | OTIIMA SPAIN

— LOCATION  
SPAIN

— ARCHITECTURE  
NORDEST ARQUITECTURA

— PHOTOGRAPHY  
ADRIÀ GOULA

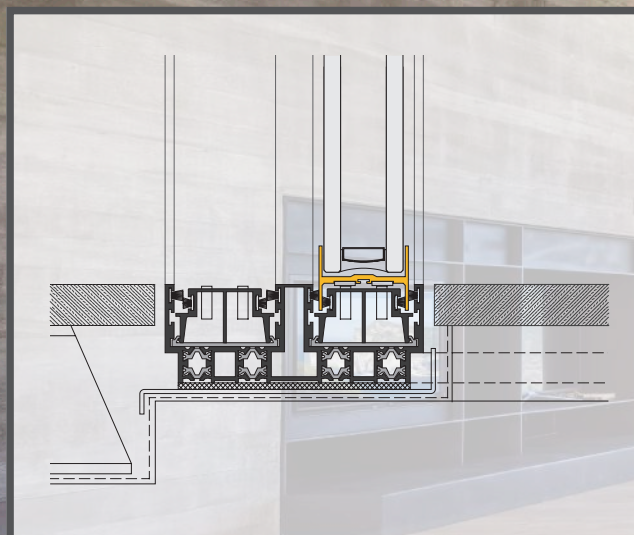



Much  
more  
than a  
window.

**OTIIMA**

— NAME  
DUNAS DOURADAS

— USED SYSTEM  
OTIIMA DRAIN

— WORK BY  
ECOSTEEL | OTIIMA PORTUGAL

— LOCATION  
PORTUGAL

— ARCHITECTURE  
JUTTA HOEN

— PHOTOGRAPHY  
SHAUN FISHER



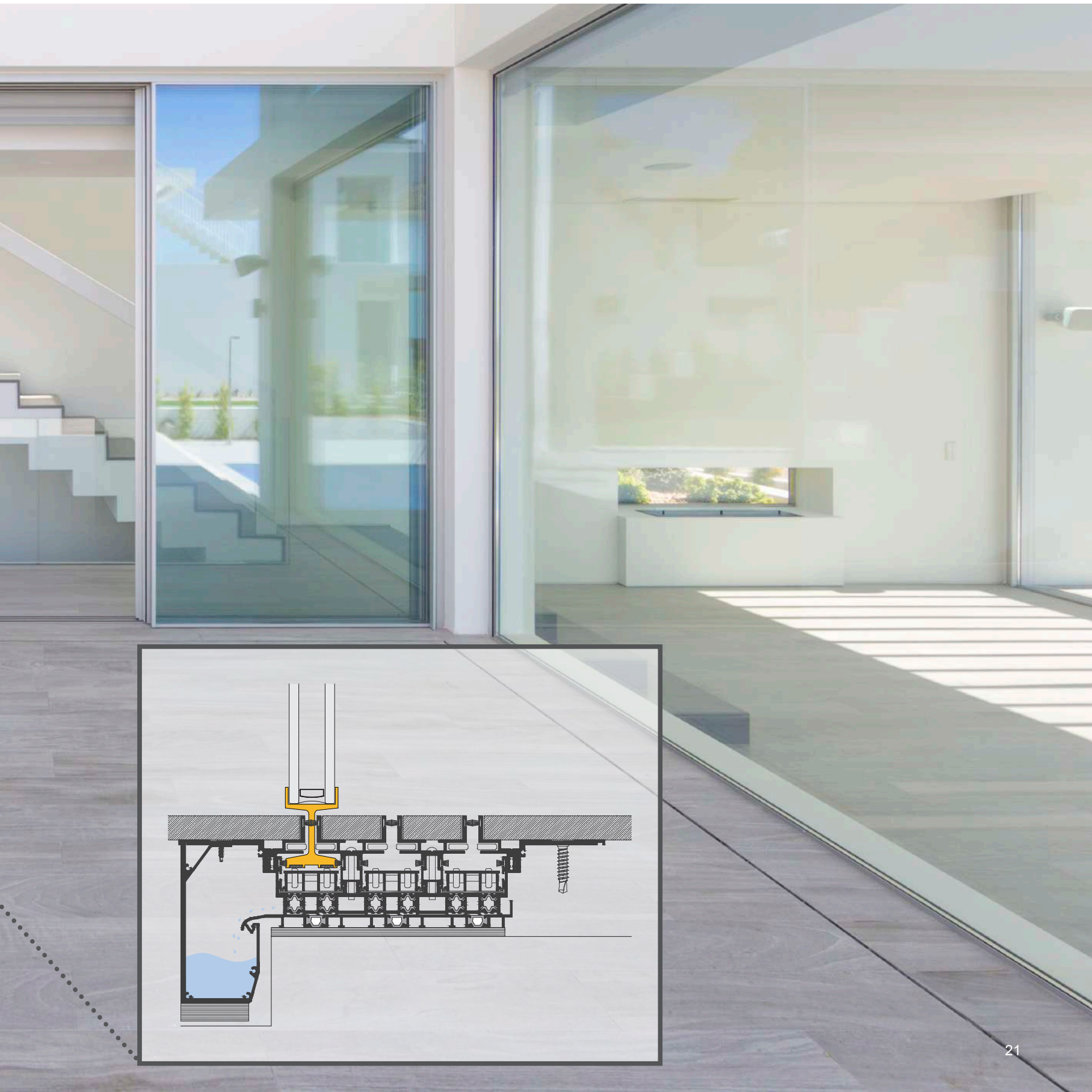

Much more than a window.

**OTIIMA**



## OTIIMA CLASSIC

OTIIMA CLASSIC uses a toughened glass that allows an optimized resistance, for large glazed panels. Vertical profiles with only 20mm thick, prepared for a superior thermal, water and air permeability performances. Rim profiles with reinforced binding polyamides for an improved thermal insulation performance.

Available in the following opening typologies:

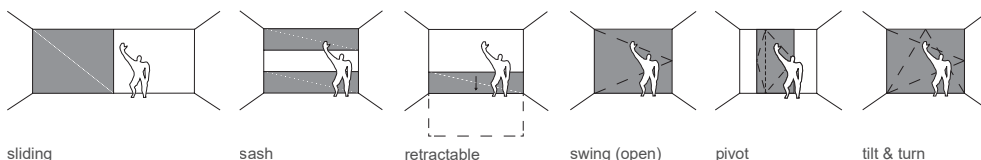

sliding

sash

retractable

swing (open)

pivot

tilt & turn



## OTIIMA PLUS

OTIIMA PLUS is an exclusive and innovative minimal window system with all the rim profiles perfectly flushed to the construction materials. This system provides to the glazed panels a superior stability by using vertical and horizontal bearings, offering also an outstanding performances in water tightness, air permeability and resistance to wind loads.

Available in the following opening typologies:

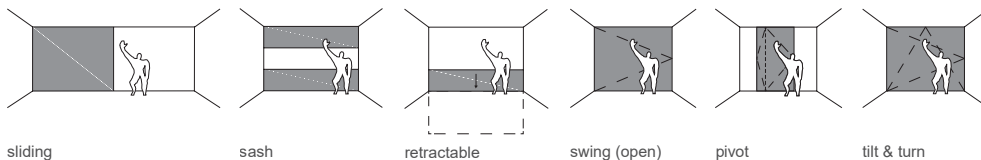

sliding

sash

retractable

swing (open)

pivot

tilt & turn



## OTIIMA DRAIN

OTIIMA DRAIN is an exclusive sliding system with vertical stainless-steel bearings, for a smooth and effortless manual opening. It includes a drainage profile channel, that is capable of draining large amounts of rainwater, even in extreme rainfall situations.

Available in the following opening typologies:

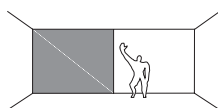

sliding





classic | plus | drain | fusion | flex | larglass

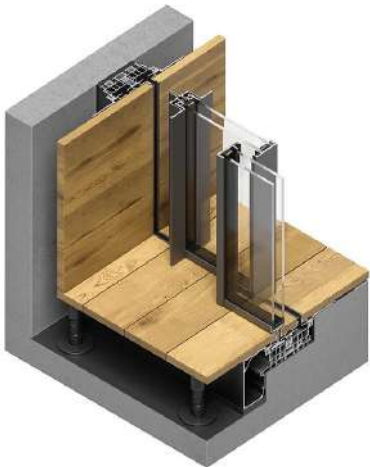

## OTIIMA FUSION

OTIIMA FUSION is a window system without any visible rim profile. A system fully integrated on the finishing materials, as if the window had been merged with the building, becoming a whole. In addition, FUSION incorporates a gutter capable of channelling a large amount of rainwater, even in extreme weather conditions.

Available in the following opening typologies:

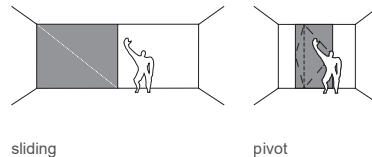

sliding

pivot



## OTIIMA FLEX

OTIIMA FLEX is an architectural glazing system designed by the architect Carvalho de Araújo. It combines the highest technical performance of today's most demanding standards in the construction market, with the elegance of minimalist steel and wooden frames hand-made by metalworkers.

Available in the following opening typologies:

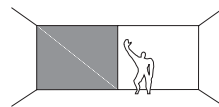

sliding

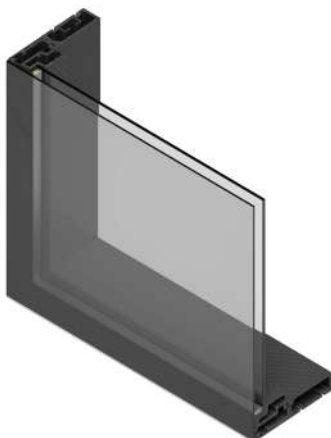

## OTIIMA LARGLASS

OTIIMA LARGLASS is a VEC curtain wall system, made up of the latest fiberglass profile technology obtained by pultrusion process, which was developed for fenestrations and facades when a full exterior view of glass is desired. It also provides low thermal conductivity, that meet demanding energy efficiency certifications.

Available in the following opening typologies:

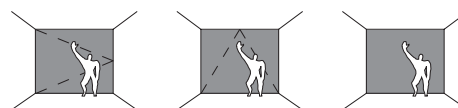

swing (open)

tilt

fixed

Much more than a window.

**OTIIMA**

**NEW!**

**OTIIMA**  
**OPEN**

- 
- 
- 

Perimeter profiles with the same size and appearance as the sliding windows. You may now experience tilt & turn, swing (open) and pivoting doors in the same façade without noticing any visual difference between the several window opening solutions.

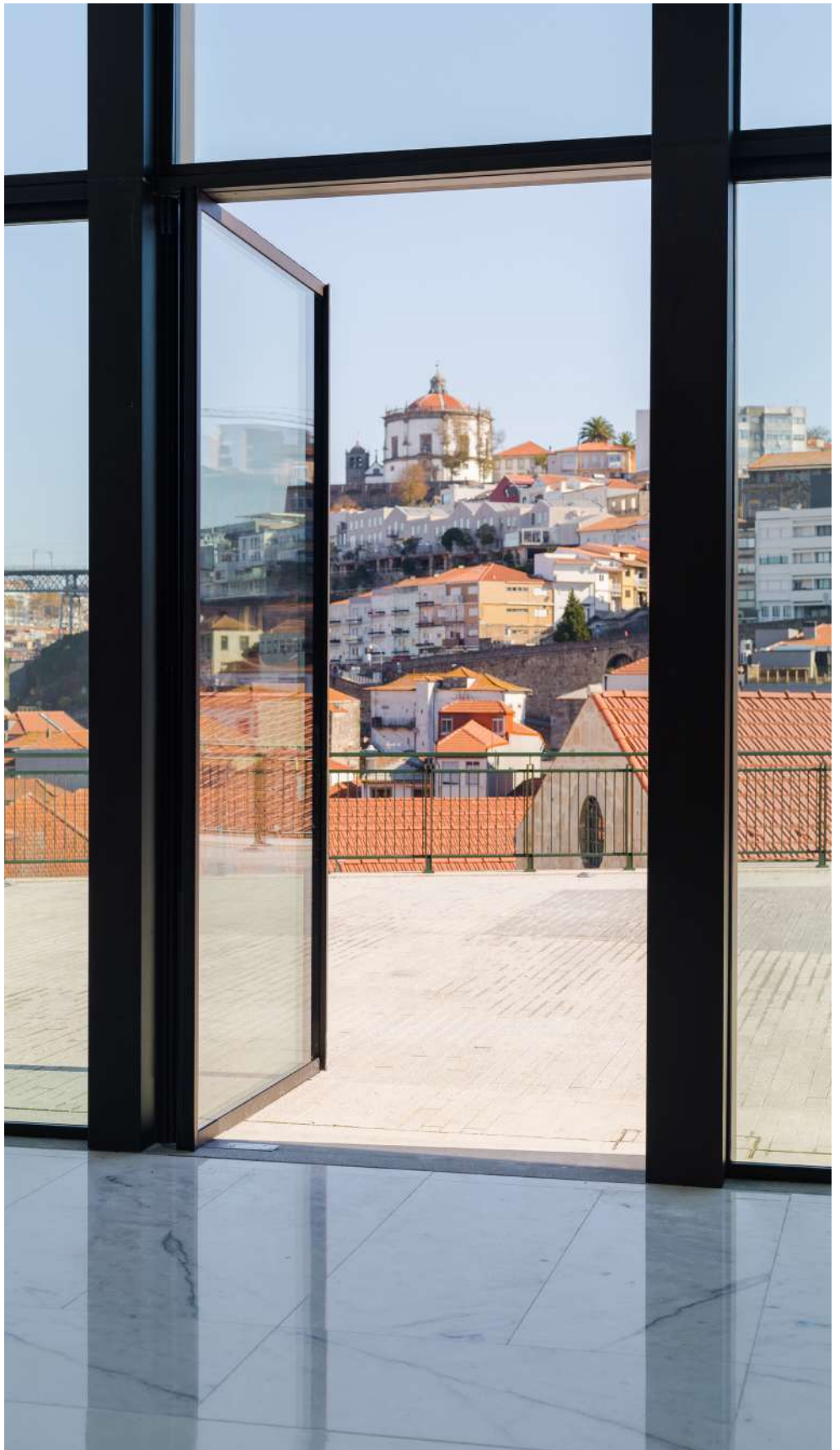
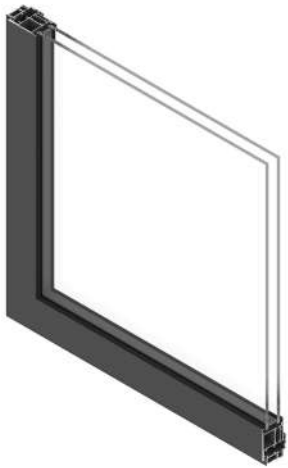

- 
- 
- 

open | pivoting

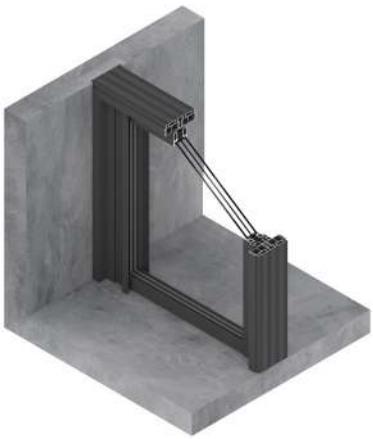

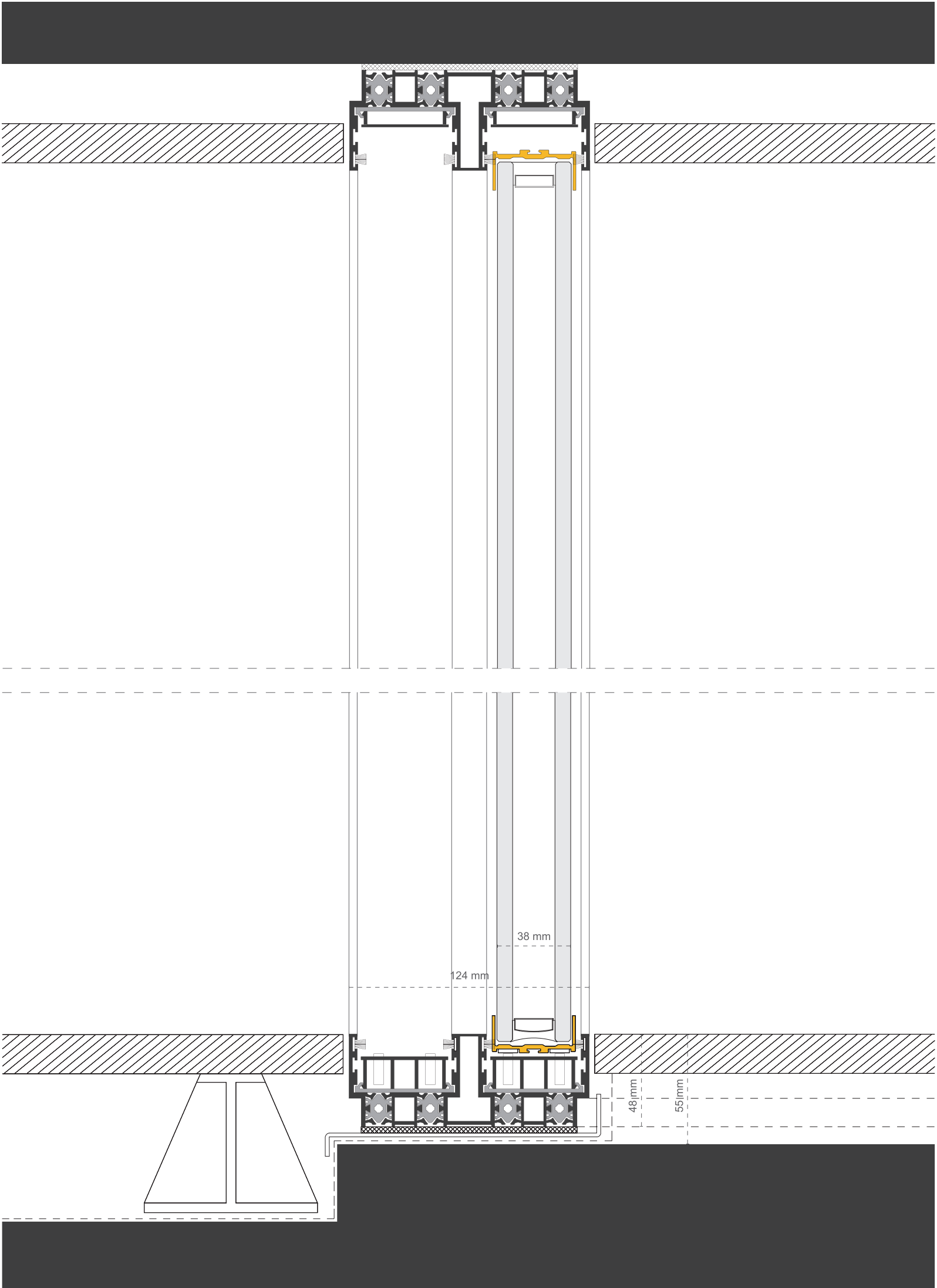







With 20mm thick vertical interlocks, **OTIIMA CLASSIC** allows large surfaces per glazed panel, offering excellent watertightness performance levels, air permeability, wind-load resistance and thermal insulation.

A standard system, with excellent performance levels.

The system uses a toughened glass that allows a superior resistance, with large surfaces. Exclusive sliding system with vertical stainless-steel bearings, for smooth, effortless manual opening.

Vertical 20mm thick profiles prepared for superior thermal, water and air permeability performances, as well as strong wind-load resistance.

	<b>Watertightness</b> ISO EN 12208 + ISO EN 1027	<b>8A</b> (450 Pa or 95 Km/h)
	<b>Air Permeability</b> ISO EN 12207 + ISO EN 1026	<b>Class 3</b> (600 Pa or 110Km/h)
	<b>Wind Resistance</b> ISO EN 12210 + ISO EN 12211	<b>Class C5</b> (2000 Pa or 200 Km/h)
	<b>Impact Resistance</b> ISO EN 12600 + ISO EN 1630	<b>Class 5</b> (In 6 possible classes)
	<b>Acoustic Insulation</b> ISO EN 10140 + ISO EN 717	<b>Rw: 38 db (up to)</b>
	<b>Security</b> ISO EN 1627	<b>RC2:(WK2)</b>
	<b>Thermal transmittance</b> U <sub>w</sub>	<b>up to</b> U <sub>g</sub> = 0.7 <b>Uw 1.2 W/ m² K</b>

Calculation module 4.60 x 3.00 to Thermal transmittance  
ISO EN 10077-1 + ISO EN 10077-2 (up to)



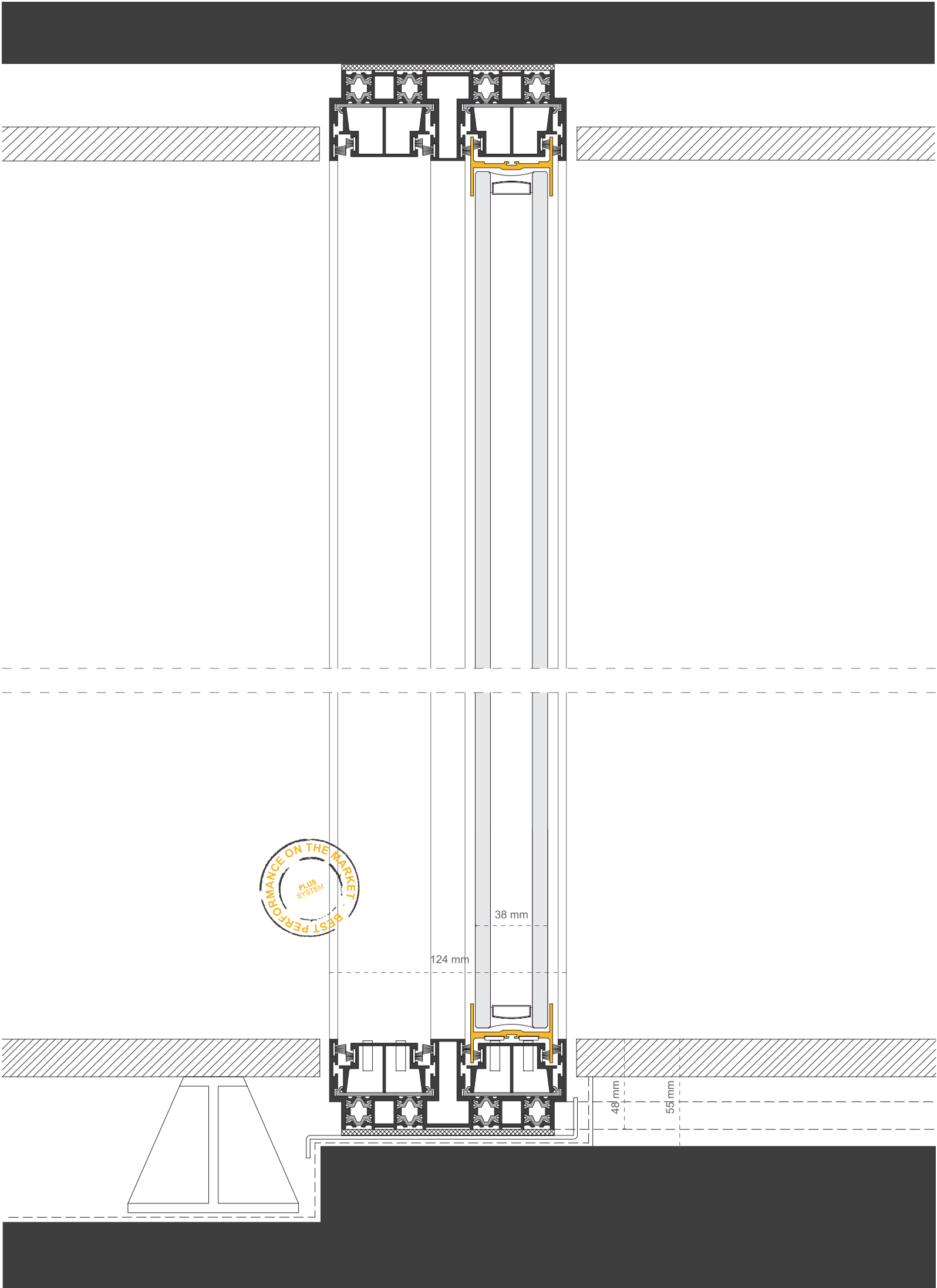

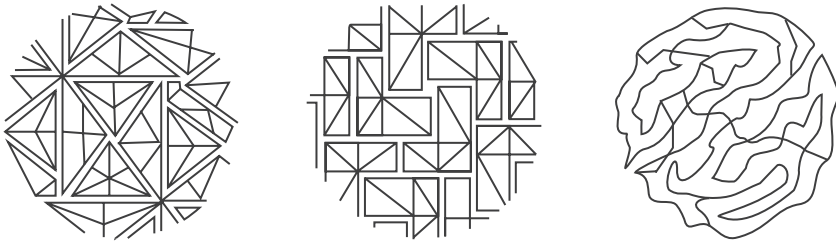

Download the app **MMTW AR** in Google Play or Apple Store and experience OTIIMA PLUS in 3D by pointing your phone to the rounded shape icons.

The exclusive invisible lock and a unique flush system are what characterizes **OTIIMA PLUS**, a system with head and sill frames perfectly flushed with the construction materials.

**PLUS** is an exclusive minimal window system, characterized by an innovative design (bottom and top position), with all window frames perfectly flush with the construction materials. It offers an outstanding performance in watertightness, air permeability and resistance to wind loads.

**PLUS** has a slim and elegant handle, equipped with a hidden lock system, that provides the window a streamlined appearance, leading to the limit of the minimal essence, allowing also an improved level of security, combined with an intuitive and simple user experience.

	<b>Watertightness</b> ISO EN 12208 + ISO EN 1027	<b>E1050</b> (3 classes above 9A)
	<b>Air Permeability</b> ISO EN 12207 + ISO EN 1026	<b>Class 4</b> (600 Pa or 110Km/h)
	<b>Wind Resistance</b> ISO EN 12210 + ISO EN 12211	<b>Class C5</b> (2000 Pa or 200 Km/h)
	<b>Impact Resistance</b> ISO EN 12600 + ISO EN 1630	<b>Class 5</b> (In 6 possible classes)
	<b>Acoustic Insulation</b> ISO EN 10140 + ISO EN 717	<b>Rw: 42db (up to)</b>
	<b>Security</b> ISO EN 1627	<b>RC2:(WK2)</b>
	<b>Thermal transmittance</b> U <sub>w</sub>	<b>up to</b> U <sub>g</sub> = 0.7 <b>U<sub>w</sub> 1.2 W/ m<sup>2</sup> K</b>

Calculation module 4.60 x 3.00 to Thermal transmittance  
ISO EN 10077-1 + ISO EN 10077-2 (up to)



reddot award 2017  
winner

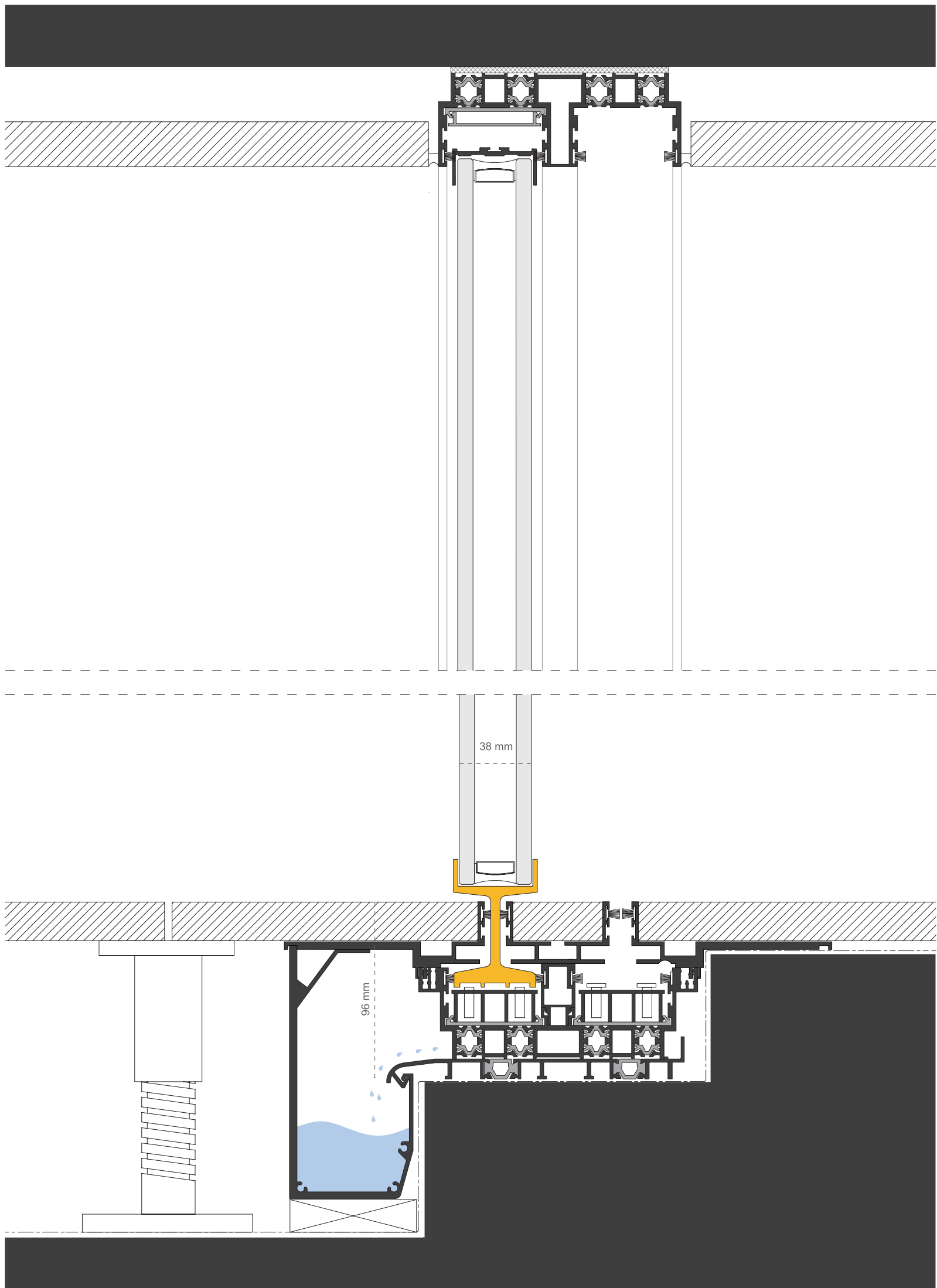









With 20mm thick vertical interlocks, **OTIIMA DRAIN** includes a drainage profile channel, that has the ability to drain large amounts of rainwater, even in extreme rainfall situations.

This complementary system is available for large surfaces per glazed panel, and does not compromise the water tightness performance levels, air permeability, wind-load resistance and thermal insulation.

OTIIMA DRAIN is designed with an exclusive sliding system with vertical stainless-steel bearings, for a smooth and effortless manual opening.

	<b>Thermal transmittance</b> U <sub>w</sub> Up to 1.0	<b>(ug 0.7)</b>
	<b>Watertightness</b> ISO EN 12208 + ISO EN 1027	<b>E1650</b> (7 classes above 9A)
	<b>Air Permeability</b> ISO EN 12207 + ISO EN 1026	<b>Class 4</b> (600 Pa or 110Km/h)
	<b>Wind Resistance</b> ISO EN 12210 + ISO EN 12211	<b>Class C3</b> (1200 Pa or 155 Km/h)
	<b>Impact Resistance</b> ISO EN 12600 + ISO EN 1630	<b>Class 5</b> (In 6 possible classes)
	<b>Acoustic Insulation</b> ISO EN 10140 + ISO EN 717	<b>Rw: 38db</b>
	<b>Security</b> ISO EN 1627	<b>RC2:(WK2)</b>

**Calculation module 4,60 x 3,00**  
ISO EN 10077-1 + ISO EN 10077-2 (up to)



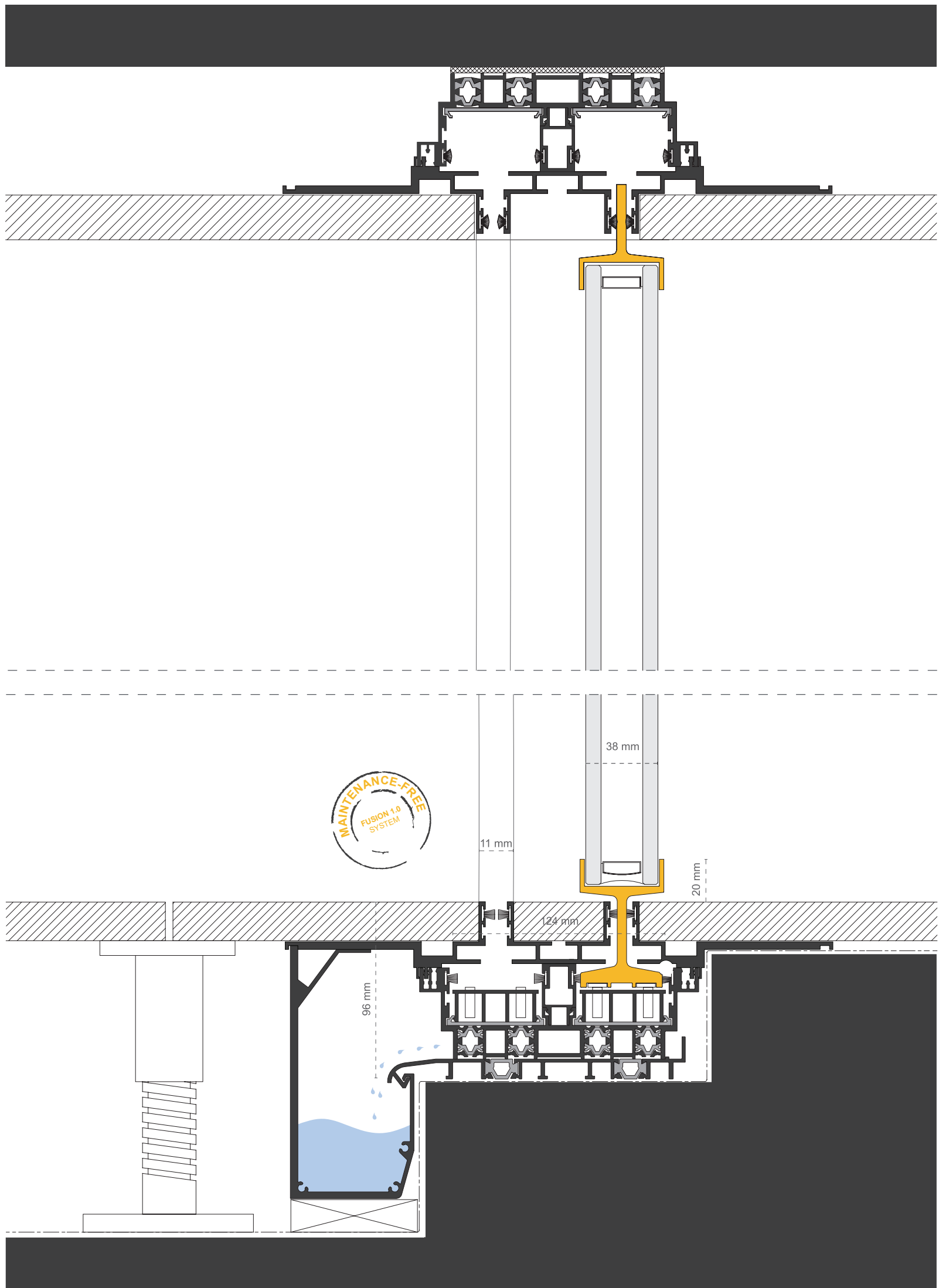







# OTIIMA FUSION 1.0

## technical details

**OTIIMA FUSION 1.0** is a system that is completely merged within the architectural and finishing materials, offering: hidden head, sill and jamb frames. Besides, it is a system that requires no maintenance due to the minimal visible slot, that inhibit leaves or other natural dirt to accumulate on its cavity. The window totally merges with the building, becoming one.

**FUSION 1.0** stands out as a system which is completely built into the finishing materials, as if the window is merged with the building, becoming one. This system incorporates the window frames with reinforced binding polyamides and toughened glass, providing superior thermal and structural performance. It's an innovative system, completely built-in on all four sides of the frame, providing the perfect fusion and a seamless connection with the interior and exterior spaces. In addition, **FUSION 1.0** incorporates a gutter capable of draining a large amount of rainwater even in extreme situations (see OTIIMA DRAIN complementary system). This system has achieved exceptional results in leakage tests, with an e1650 class exceptional, (7 classes above class 9a) according to en 12208 + ISO en 1027.

	<b>Watertightness</b> ISO EN 12208 + ISO EN 1027	<b>E1650</b> (7 classes above 9A)
	<b>Air Permeability</b> ISO EN 12207 + ISO EN 1026	<b>Class 4</b> (600 Pa or 110Km/h)
	<b>Wind Resistance</b> ISO EN 12210 + ISO EN 12211	<b>Class C5</b> (2000 Pa or 200 Km/h)
	<b>Impact Resistance</b> ISO EN 12600 + ISO EN 1630	<b>Class 5</b> (In 6 possible classes)
	<b>Acoustic Insulation</b> ISO EN 10140 + ISO EN 717	<b>Rw: 42db (up to)</b>
	<b>Security</b> ISO EN 1627	<b>RC2:(WK2)</b>
	<b>Thermal transmittance</b> Uw Ug = 0.7	<b>up to</b> <b>Uw 1.0 W/ m² K</b>

Calculation module 4.60 x 3.00 to Thermal transmittance  
ISO EN 10077-1 + ISO EN 10077-2 (up to)



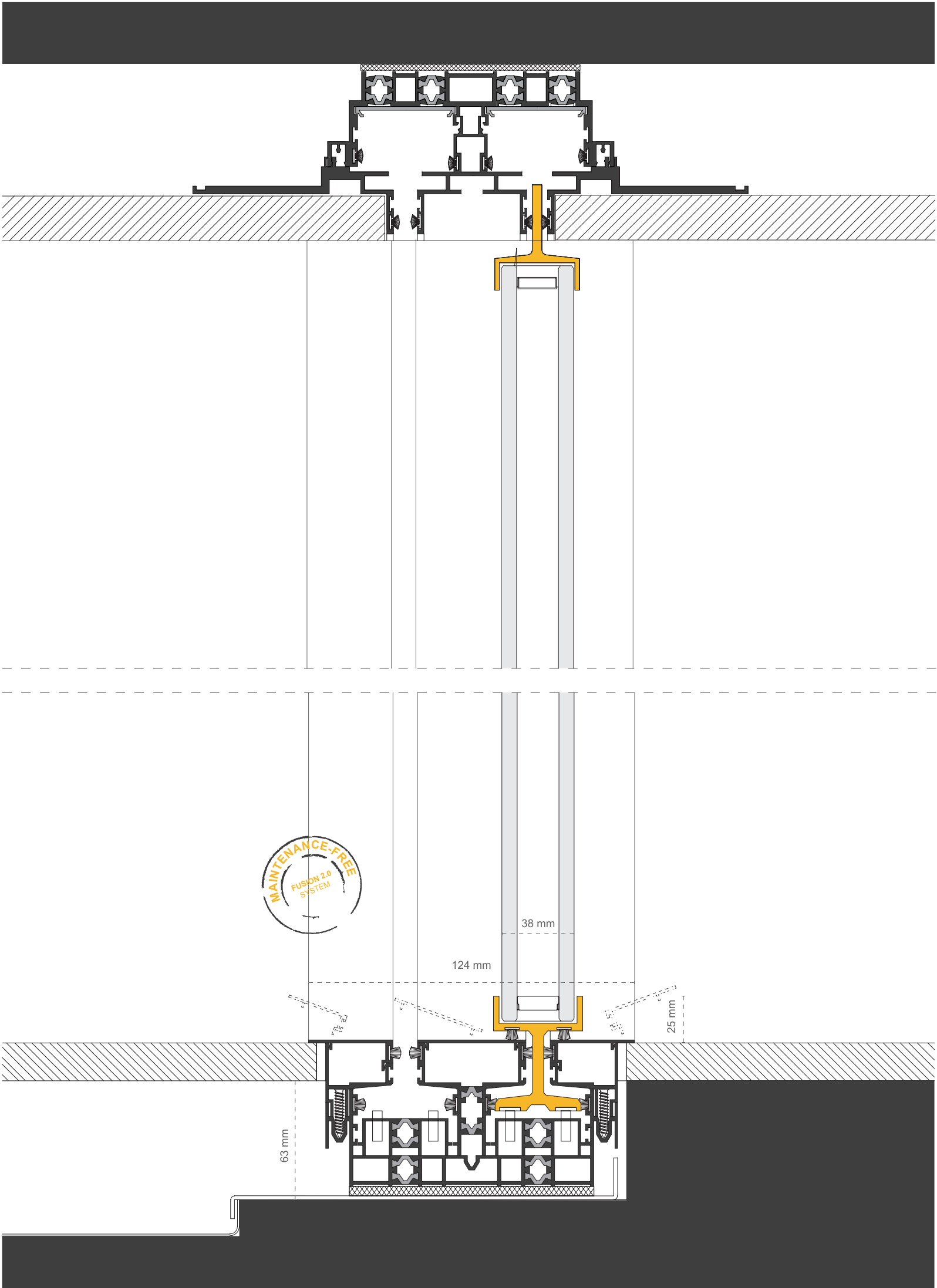







**OTIIMA FUSION 2.0** is the most balanced system in the market, in what concerns about design, performance and maintenance. Besides, it is a system that requires no maintenance due to the minimal visible slot, that inhibit leaves or other natural dirt to accumulate on its cavity. This system enables easy access to technical cavities, removable and replaceable covers. Additional drainage grid and anti-freeze.

**FUSION 2.0** is the new minimalist sliding system from **OTIIMA** | Much more than a window that merges design, performance and maintenance in an innovative and exceptional way, combining the best thermal, acoustic and air/water permeability performances with superior design to perfectly blend and harmonize with the building. Unique maintenance features, like the easy replacement of the finishing caps at any time throughout the lifespan of the building, during or after construction, that can even be done by the end user.

The system also features perimeter cavities below the removable finishing caps, that can be transformed into technical spaces for multiple uses, such as extra mechanical fixings, thermal probes for heating, insulation, lighting or weather sensors.

	<b>Watertightness</b> ISO EN 12208 + ISO EN 1027	<b>E1650</b> (7 classes above 9A)
	<b>Air Permeability</b> ISO EN 12207 + ISO EN 1026	<b>Class 4</b> (600 Pa or 110Km/h)
	<b>Wind Resistance</b> ISO EN 12210 + ISO EN 12211	<b>Class C5</b> (2000 Pa or 200 Km/h)
	<b>Impact Resistance</b> ISO EN 12600 + ISO EN 1630	<b>Class 5</b> (In 6 possible classes)
	<b>Acoustic Insulation</b> ISO EN 10140 + ISO EN 717	<b>Rw: 42db (up to)</b>
	<b>Security</b> ISO EN 1627	<b>RC2:(WK2)</b>
	<b>Thermal transmittance</b> U <sub>w</sub>	<b>up to</b> U <sub>g</sub> = 0.7 <b>U<sub>w</sub> 1.0 W/ m² K</b>

Calculation module 4.60 x 3.00 to Thermal transmittance  
ISO EN 10077-1 + ISO EN 10077-2 (up to)



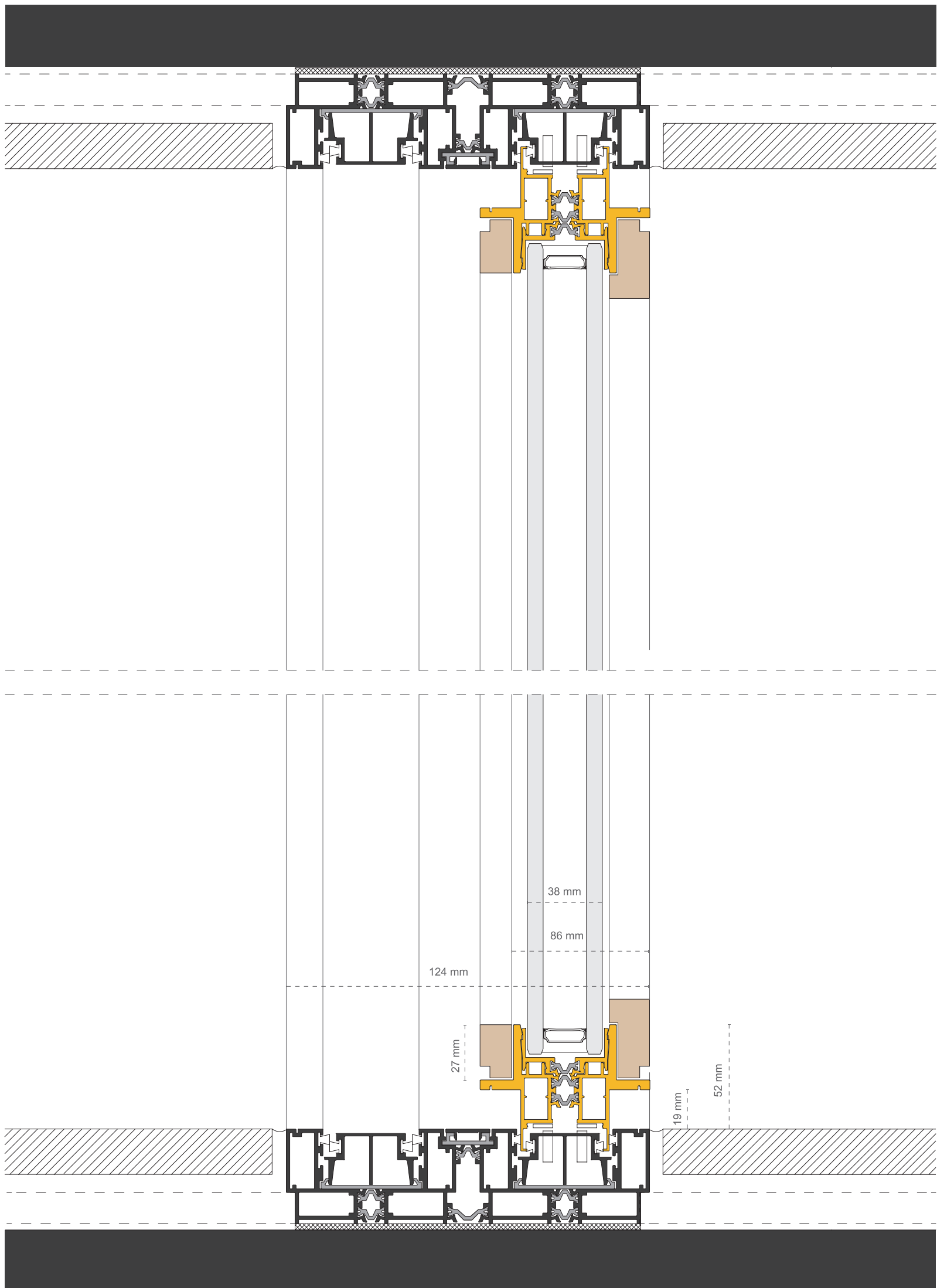







“Sometimes we want to merge the window in the building to a minimal expression.

Sometimes we want to have a visual frame, a window enhancement as a composition element. Other times we want both expressions to value a particular composition.”

José Manuel Carvalho Araújo

**FLEX** frame is an architectural glazing system, that combines the highest technical performance of today's most demanding standards in the construction market, with the elegance and delicateness of minimalist steel and wooden frames hand-made by metalworkers, with the purpose of catering for the different types of frames in a single solution, with maximum visual language, blending the result within the construction for a plain and simple appearance

**FLEX** frame optionally allows for the inclusion of a decorative wooden sub-frame in different sizes, which can add character, enhancing the window and making it an essential element of the architectural composition.

	<b>Watertightness</b> ISO EN 12208 + ISO EN 1027	<b>E 950</b> (2 classes above 9A)
	<b>Air Permeability</b> ISO EN 12207 + ISO EN 1026	<b>Class 3</b> (600 Pa or 110Km/h)
	<b>Wind Resistance</b> ISO EN 12210 + ISO EN 12211	<b>Class 3</b> (1200 Pa or 155 Km/h)
	<b>Impact Resistance</b> ISO EN 12600 + ISO EN 1630	<b>Class 5</b> (In 6 possible classes)
	<b>Acoustic Insulation</b> ISO EN 10140 + ISO EN 717	<b>Rw: 42db (up to)</b>
	<b>Security</b> ISO EN 1627	<b>RC2:(WK2)</b>
	<b>Thermal transmittance</b> U <sub>w</sub> Ug = 0.7	<b>up to</b> <b>U<sub>w</sub> 1.2 W/ m<sup>2</sup> K</b>

Calculation module 4.60 x 3.00 to Thermal transmittance  
ISO EN 10077-1 + ISO EN 10077-2 (up to)



anodized structural tube,  
painted in the designated colour

subframe  
and fixation

pultruded fibreglass  
profile

overlapped double  
glazing

**OTIIMA  
innovation**

costumized  
fibreglass  
solution

anodized aluminium plate,  
painted in the designated colour



Minimal window frames made with fibreglass, **OTIIMA LARGLASS** offers low thermal conductivity ( $W/m K=0.40$ ) and can easily meet demanding energy efficiency certifications such as PASSIVHAUS and MINERGIE.

Fiberglass has a very low thermal transmission. As so, it is a great solution for keeping the heat inside and keeping the cold outside the building. This translates into lower electricity costs and more conscious global environmental protection. The use of fiberglass allows the reduction of the electricity bill up to approximately 50% either for heating or cooling purposes. In addition, this system completely eliminates the risk of moisture and condensation on the surface of the glass or on the profiles. Its structural resistance is much more capable than aluminium, which allows the use of slim profiles even in large glazed panes. It is highly resistant to corrosion and rotting, even in more aggressive environments.

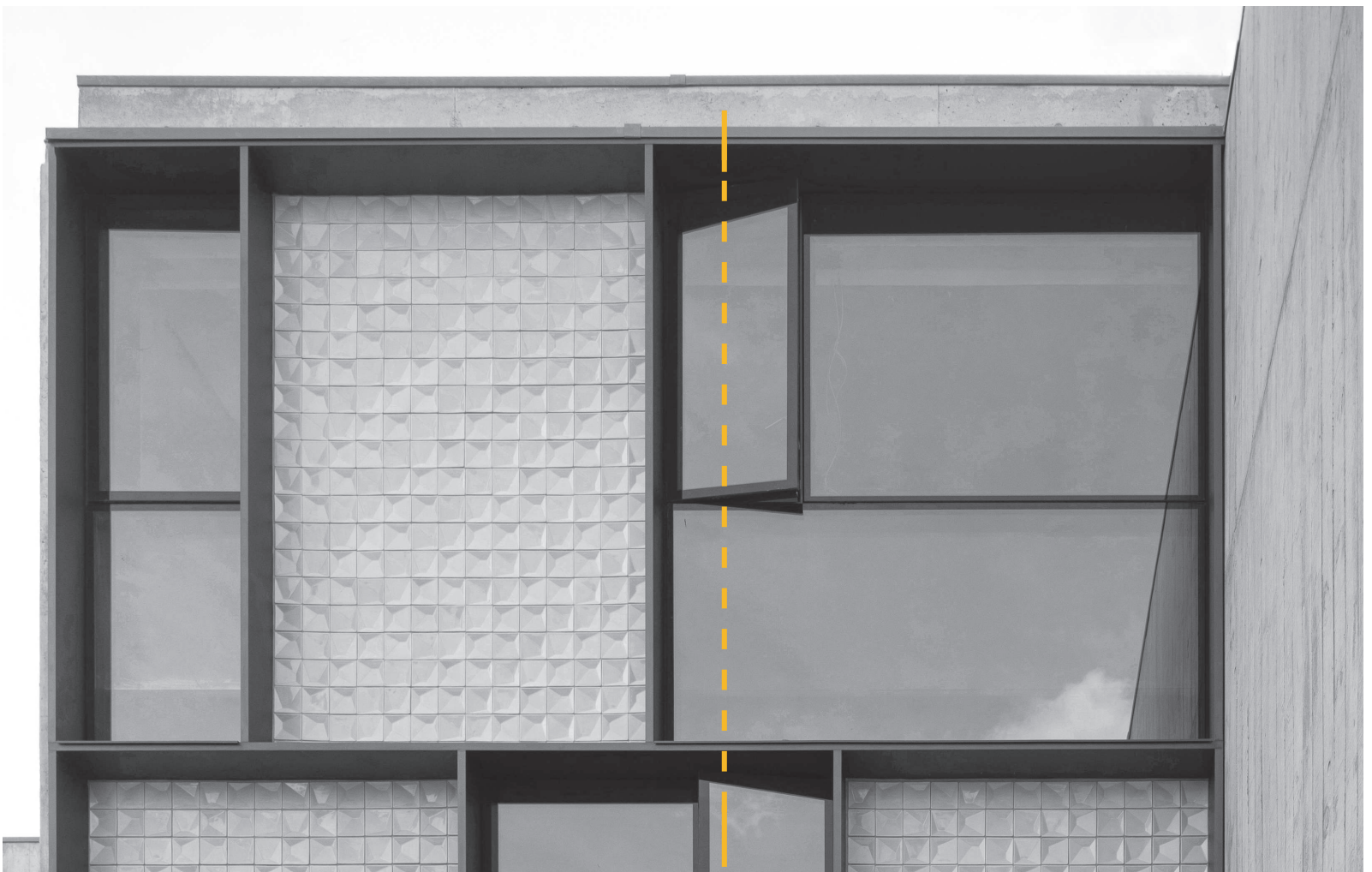
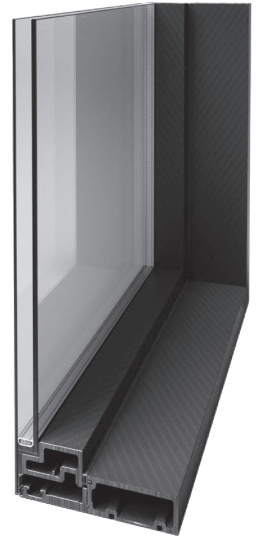

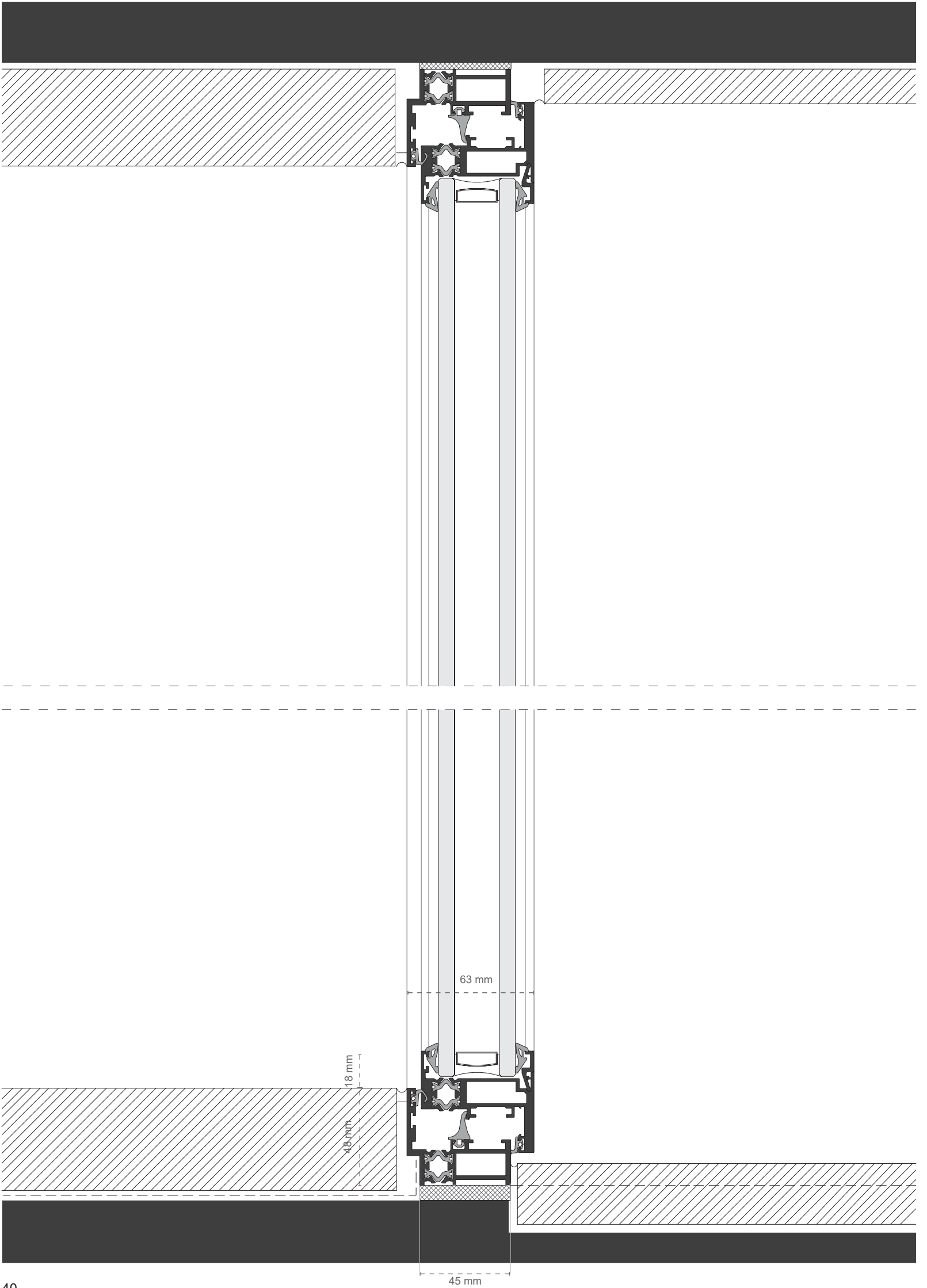







Perimeter profiles with the same size and configuration of the sliding series profiles. You may now have tilt & turn and sliding windows in the same building without noticing the difference between windows systems.

Rim profiles with reinforced binding polyamides for an improved thermal insulation performance.

Toughened double double glass allows optimized resistance and best thermal performance for your project.

	<b>Watertightness</b> ISO EN 12208 + ISO EN 1027	<b>E1200</b> (4 classes above 9A)
	<b>Air Permeability</b> ISO EN 12207 + ISO EN 1026	<b>Class 4</b> (600 Pa or 110Km/h)
	<b>Wind Resistance</b> ISO EN 12210 + ISO EN 12211	<b>Class B5</b> (2000 Pa or 200 Km/h)
	<b>Impact Resistance</b> ISO EN 12600 + ISO EN 1630	<b>Class 5</b> (In 6 possible classes)
	<b>Acoustic Insulation</b> ISO EN 10140 + ISO EN 717	<b>Rw: 38db (up to)</b>
	<b>Security</b> ISO EN 1627	<b>RC2:(WK2)</b>
	<b>Thermal transmittance</b> U <sub>w</sub> U <sub>g</sub> = 0.7	<b>up to</b> <b>U<sub>w</sub> 1.0 W/ m<sup>2</sup> K</b>

Calculation module 1,23 x 1,48 to Thermal transmittance  
ISO EN 10077-1 + ISO EN 10077-2 (up to)



Much more than a window.

OTIIMA

	CLASSIC beginning	PLUS evolution	DRAIN progress	FUSION 1.0 revolution	FUSION 2.0 excellence	FLEX authored	LARGLASS fiberglass	OPEN swing
TRACK SYSTEM	VISIBLE/ HIDDEN BEARINGS	VISIBLE	VISIBLE	HIDDEN	HIDDEN	HIDDEN	VISIBLE	
	UNEVEN/ FLUSH/ MERGED	UNEVEN	FLUSH	MERGED	MERGED	MERGED	FLUSH	
FLY SCREEN	RETRACTABLE OPENING	•	•	•		•		
	FULL FRAME	•	•	•	•	•		
LOCKING MECHANISMS	EXCLUSIVE INVISIBLE LOCK	•	•	•				
	MULTIPLE POINT LOCK	•	•	•	•	•	•	•
HURRICANE PROOF			•	•				
AUTOMATION	•	•	•	•	•	•		•
EXCLUSIVE ANTI FREEZE SYSTEM	•	•	•	•	•	•		•
LIFETIME WARRANTY	•	•	•	•	•	•	•	•
AWARDS		 reddot award 2017 winner		 Innovation 2017				
SPECIAL COLOR FRAMES *	 anodized natural	 anodized 1EA		 anodized 2EA	 anodized 3EA	 anodized 4EA	 anodized 6EA	

\*SPECIAL COLOR FRAMES ON REQUEST

# FEATURES AND CUSTOMIZATIONS

- 
- 
- 

summary

		<b>CLASSIC</b> beginning	<b>PLUS</b> evolution	<b>DRAIN</b> progress	<b>FUSION 1.0</b> revolution	<b>FUSION 2.0</b> excellence	<b>FLEX</b> authored	<b>LARGLASS</b> fiberglass	<b>OPEN</b> swing
HORIZONTAL SLIDING	STANDARD	•	•	•	•	•	•		•
	CORNER	•	•	•	•	•	•		
	HIDDEN "pocket"	•	•	•	•	•	•		
VERTICAL SLIDING	STANDARD "sash"	•	•						
	HIDDEN "retractable"	•	•						
SWING	CASEMENT	•	•				in progress	•	•
	TILT & TURN	•	•				in progress	tilt only	•
	PIVOT	•	•			•	in progress		•
GLASS TYPE	SINGLE	•							
	DOUBLE	•	•	•	•	•	•	•	•
	TRIPLE	•	•	•	•	•	•	•	•
GLASS FEATURES	SLOPED	*	*	*	*	*	*		
	CURVED	*	*	*	*	*	*		

\* SLOPED AND CURVED WINDOWS ON REQUEST

Much more than a window.

OTIIMA

HORIZONTAL SLIDING

STANDARD

CORNER

HIDDEN "pocket"

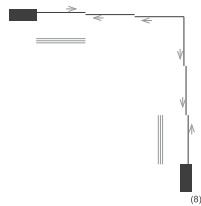
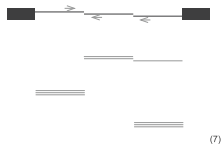
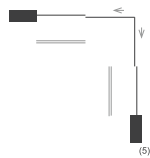
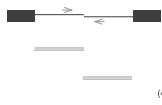
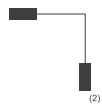

VERTICAL SLIDING

STANDARD "sash"

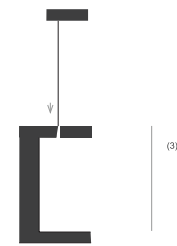
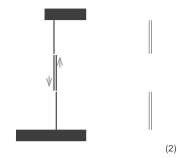
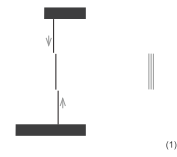

MONORAIL

FIX (1)

FIX (2)

● (3)

● (1)

TOP AND BOTTOM OPENING

BIRAIL

● (4)

● (5)

● (6)

● (2)

CENTRAL OPENING

TRIRAIL

● (7)

● (8)

● (9)

● (3)

HIDDEN "retractable"

CUSTOMIZED

\*

\*

\*

●

CUSTOMIZED

\* CUSTOMIZED ON REQUEST

# OPENING TYPOLOGIES

- 
- 
- 

summary

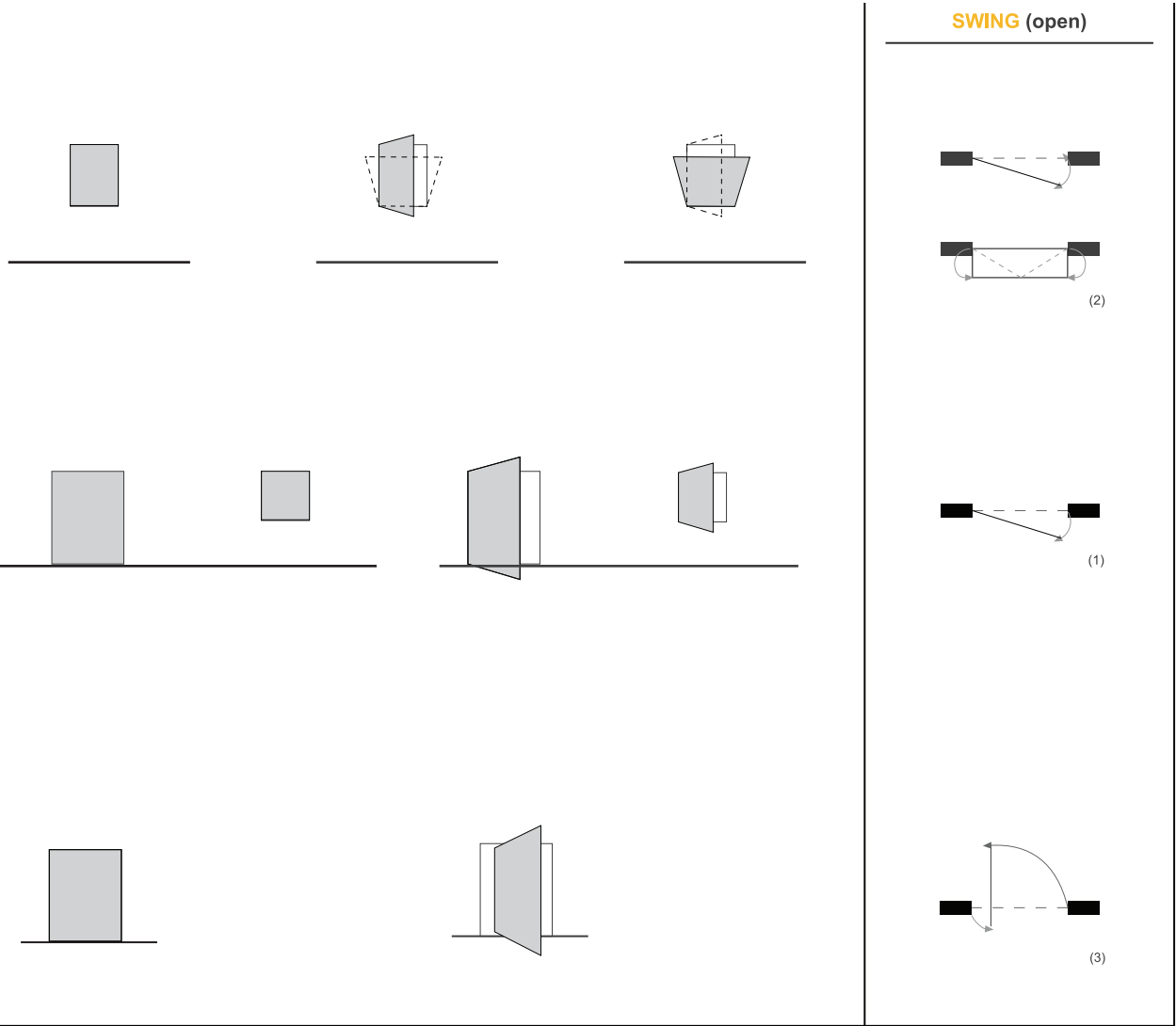

CASEMENT		● (1)
TILT & TURN		● (2)
PIVOT		● (3)
CUSTOMIZED		●

Much  
more  
than a  
window.

OTIIMA

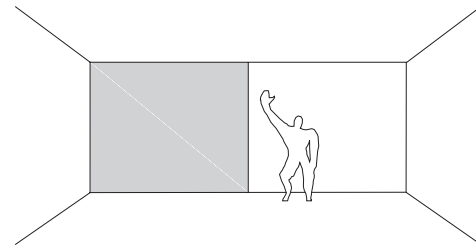
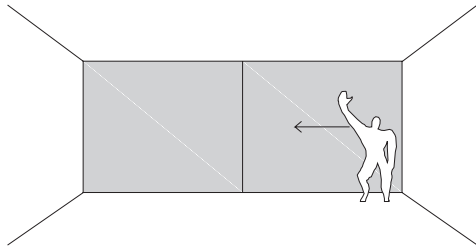

SLIDING BIRRAIL

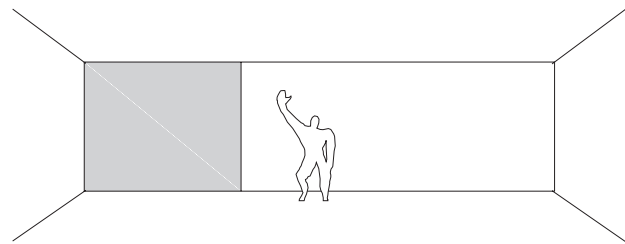
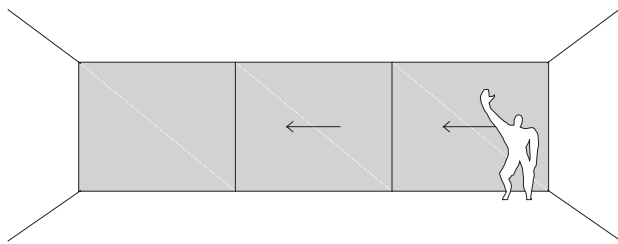

SLIDING TRIRRAIL

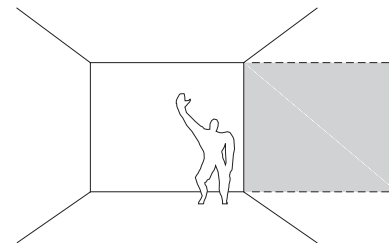
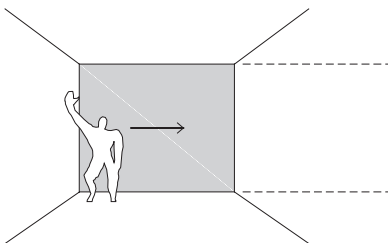

HORIZONTAL POCKET

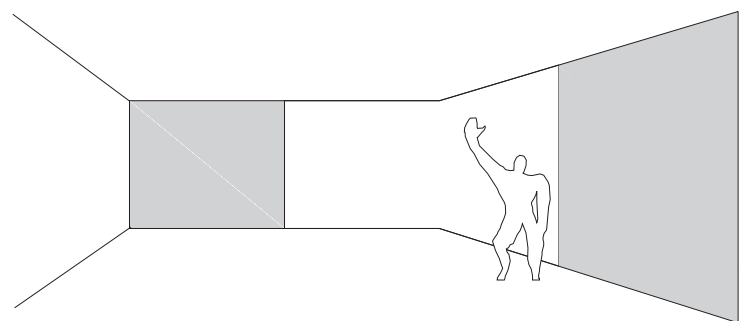
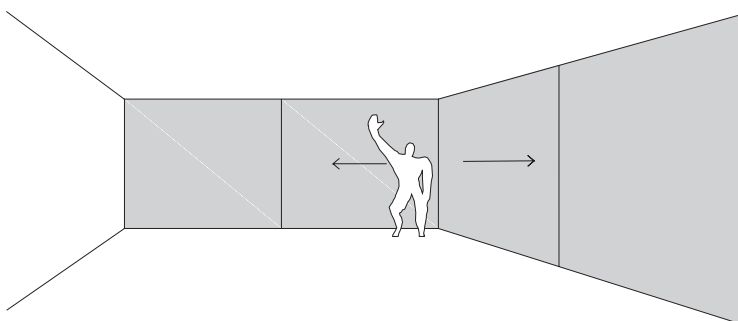

SLIDING CORNER



# OPENING TYPOLOGIES

- 
- 
- 

schemes

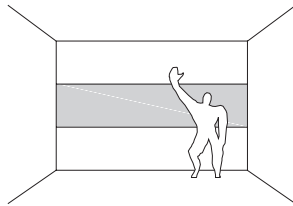
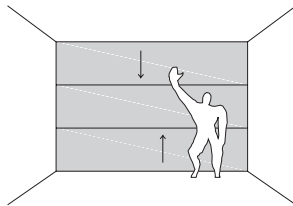
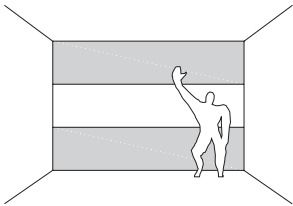
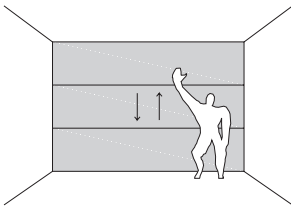

SASH (CENTRAL OPENING)

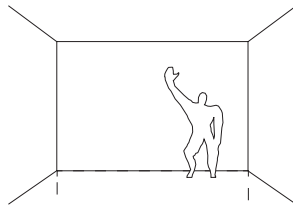
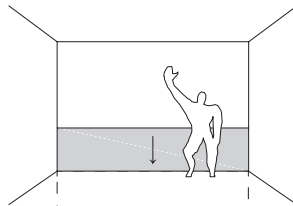
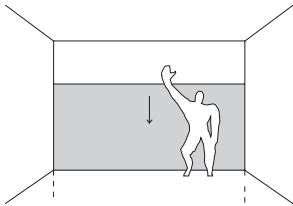
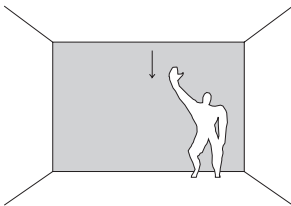

RETRACTABLE

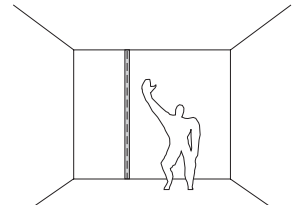
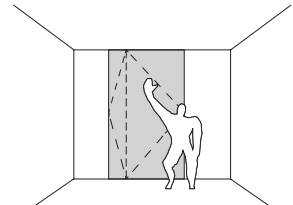
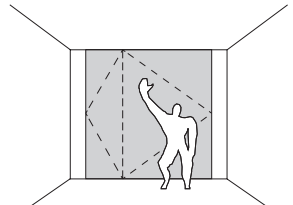
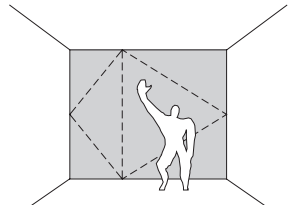

PIVOT

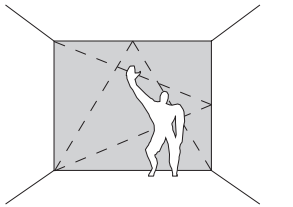
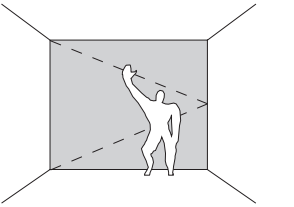
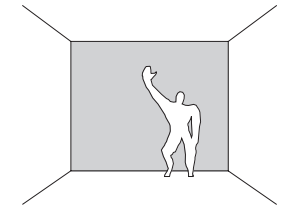

FIXED

SWING (OPEN)

TILT & TURN

Much  
more  
than a  
window.

OTIIMA

As an option, all OTIIMA's windows can be motorized, offering the option of superior, lateral or inferior installation.

OTIIMA's motorization system has now an **exclusive technology** that allows you to **easily switch from automatic to manual opening** by clutch disengagement.

This system becomes highly useful if the automatism becomes inoperable, in case of general failure of electricity and if the backup batteries get discharged.

Upon request, you may also be able to operate your windows' motorization with classic switches or by a global home automation system.

This second solution offers new possibilities for a safer and more comfortable environment.

feasable placements | automation solutions

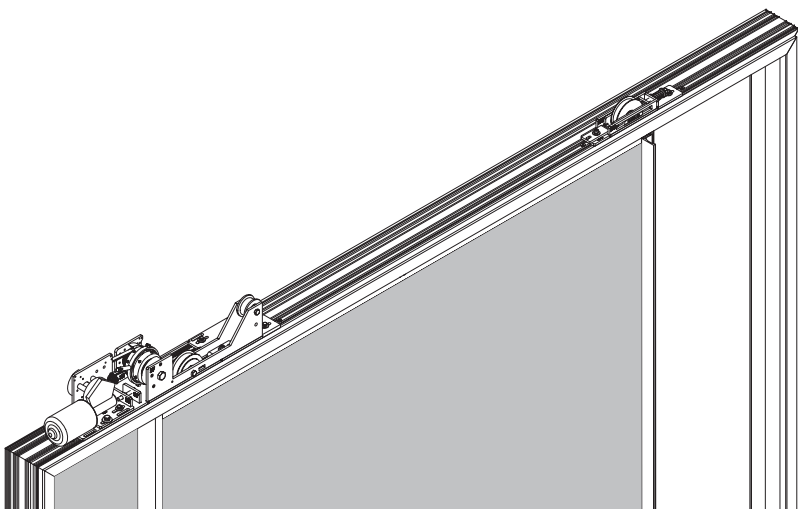
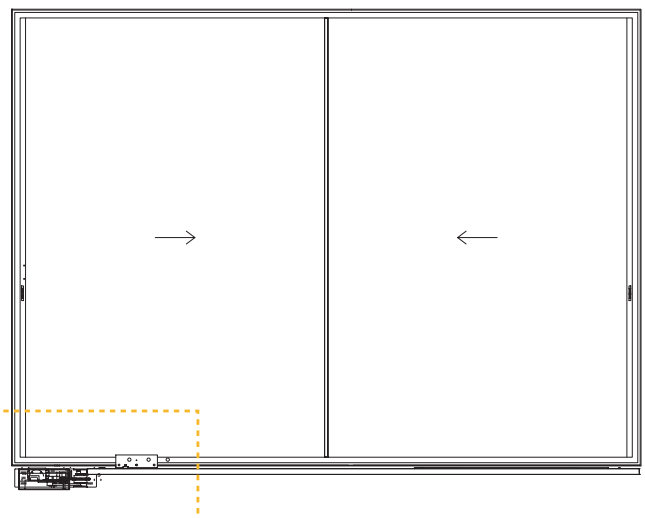
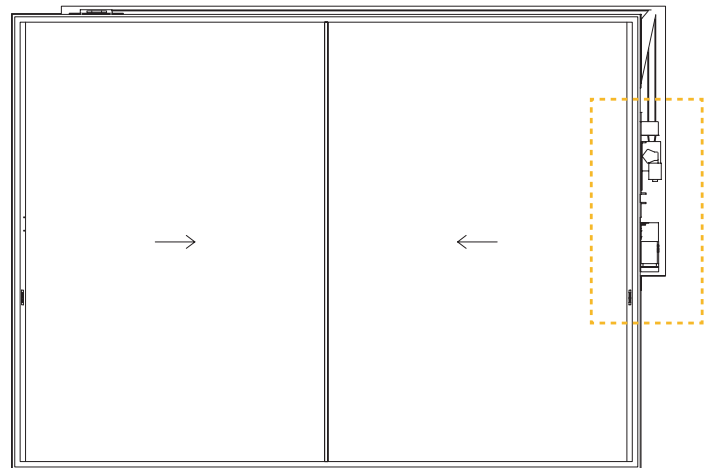
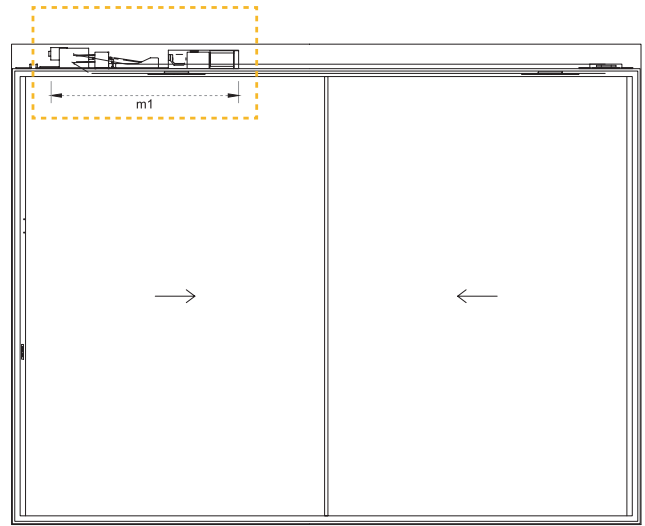

# MOTORIZATION EXAMPLES

- 
- 
- 

sliding skylight | pivoting door

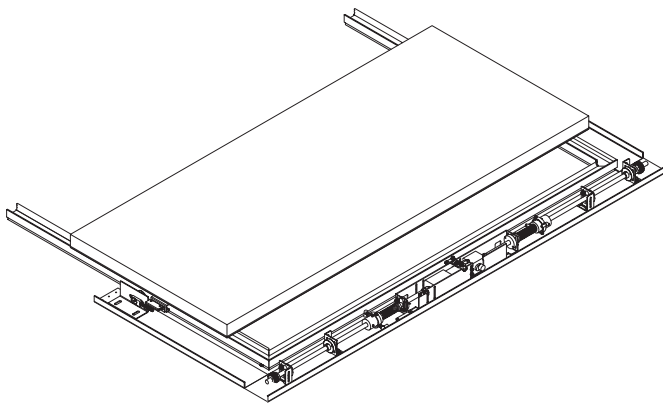

SLIDING SKYLIGHT

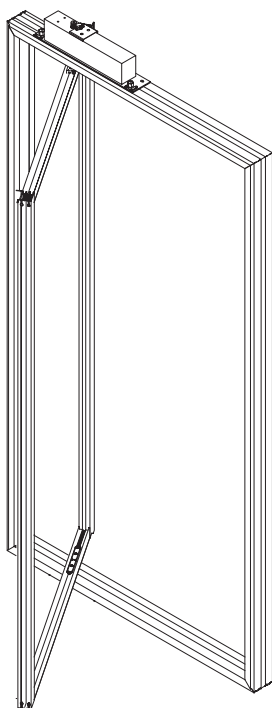
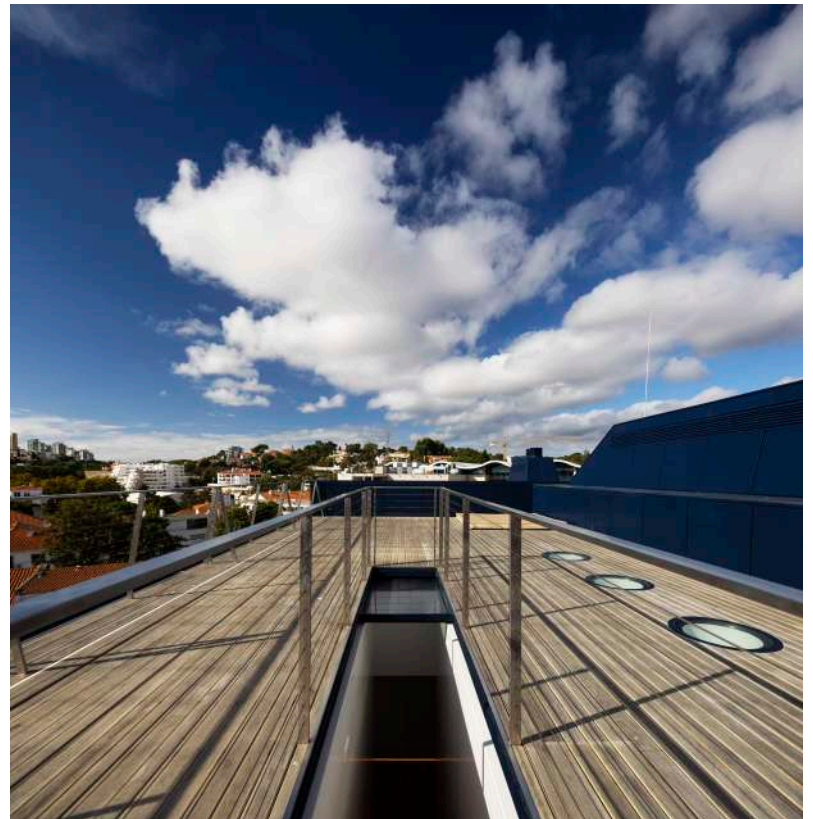

PIVOTING DOOR



Much  
more  
than a  
window.

**OTIIMA**

OTIIMA's windows may be customized with 2 different types of locks. Both of them equipped with high efficient security solutions.

**STANDARD LOCK**

is equipped with a **multiple point lock system**.

**INVISIBLE LOCK**

**exclusive invisible lock**, merged into the handle of the window, providing the most minimal lock in the market, with high security performances, also equipped with a multiple point lock system.

In addition to the traditional manual locking systems, you can choose an automatic electromagnetic lock and, for an even higher level of security, you can equip your window with alarm cells.

**ELECTROMAGNETIC LOCK**

To manage access control, or for optional security, a hidden electromagnetic lock can be included into windows.

**SAFETY SENSOR (HANDLE POSITION)**

With the safety band installed on the whole extension of the handle, the user's safety will always be guaranteed.

**ALARM**

The new generation windows provide a perfect integration of alarm cells.

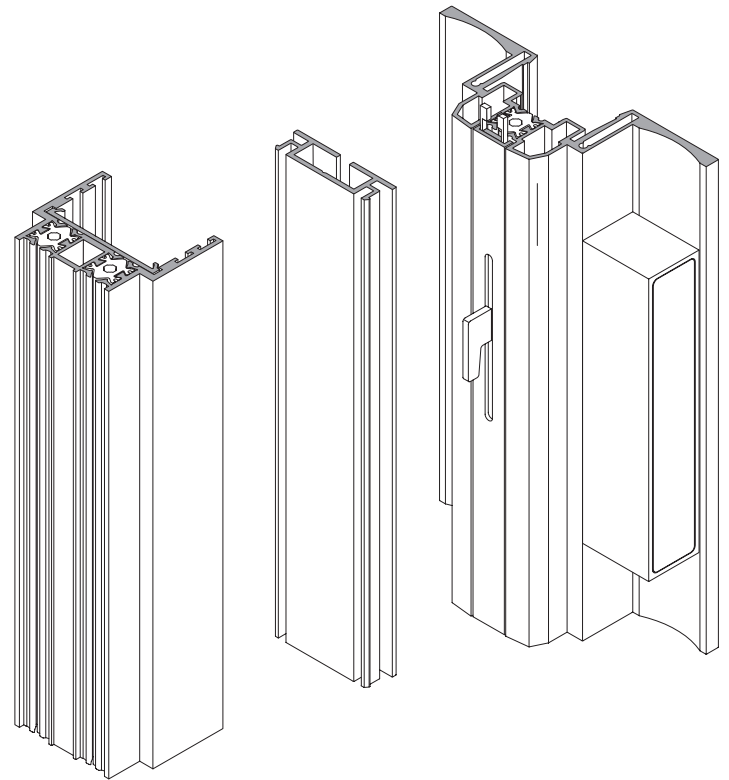

STANDARD LOCK

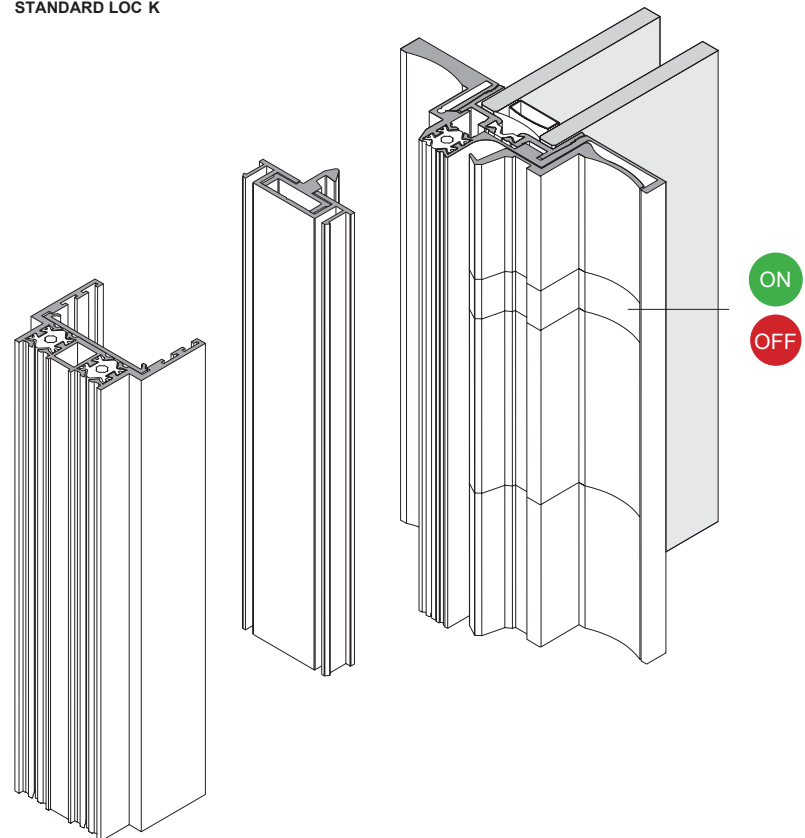

INVISIBLE LOCK

# OTIIMA'S LOCKING MECHANISMS

- 
- 
- 

available locks and handles

## ONE-HAND LOCK CONTROL

Experience a smooth locking mechanism, very easy to operate with only one hand.

## TWO-HAND LOCK CONTROL

With new generation hidden security locks, it is possible to apply a safety system where the windows opening only occurs if the operator uses both hands.

This safety system is especially effective in preventing use by children.

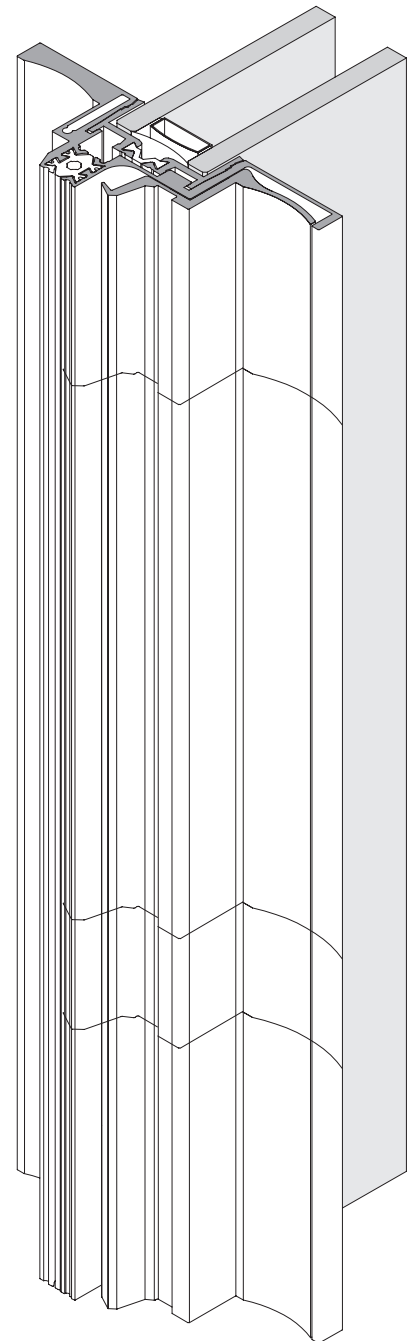

INVISIBLE LOCK

Much  
more  
than a  
window.

OTIIMA

•  
•  
•

retractable flyscreen | invisible

A mosquito net system offers you the freedom to keep the windows open without reducing visibility or air flow, and protects you from external parasites. The mosquito net can be installed standard on our sliding panels parallel to the window, indoors and outdoors, on a 3x3 meter dimension (larger dimensions on request). It can also be fixed using a retractable vertical bearing, hidden in the window cover, for a maximum opening size of 40cm.

OTIIMA's flyscreen invisible system was developed to assure the window opening for refreshing and air changing, providing absolute protection from the outside undesired insects.

•  
•  
•

OTIIMA's fly screen may be applied to OTIIMA PLUS and to DRAIN.

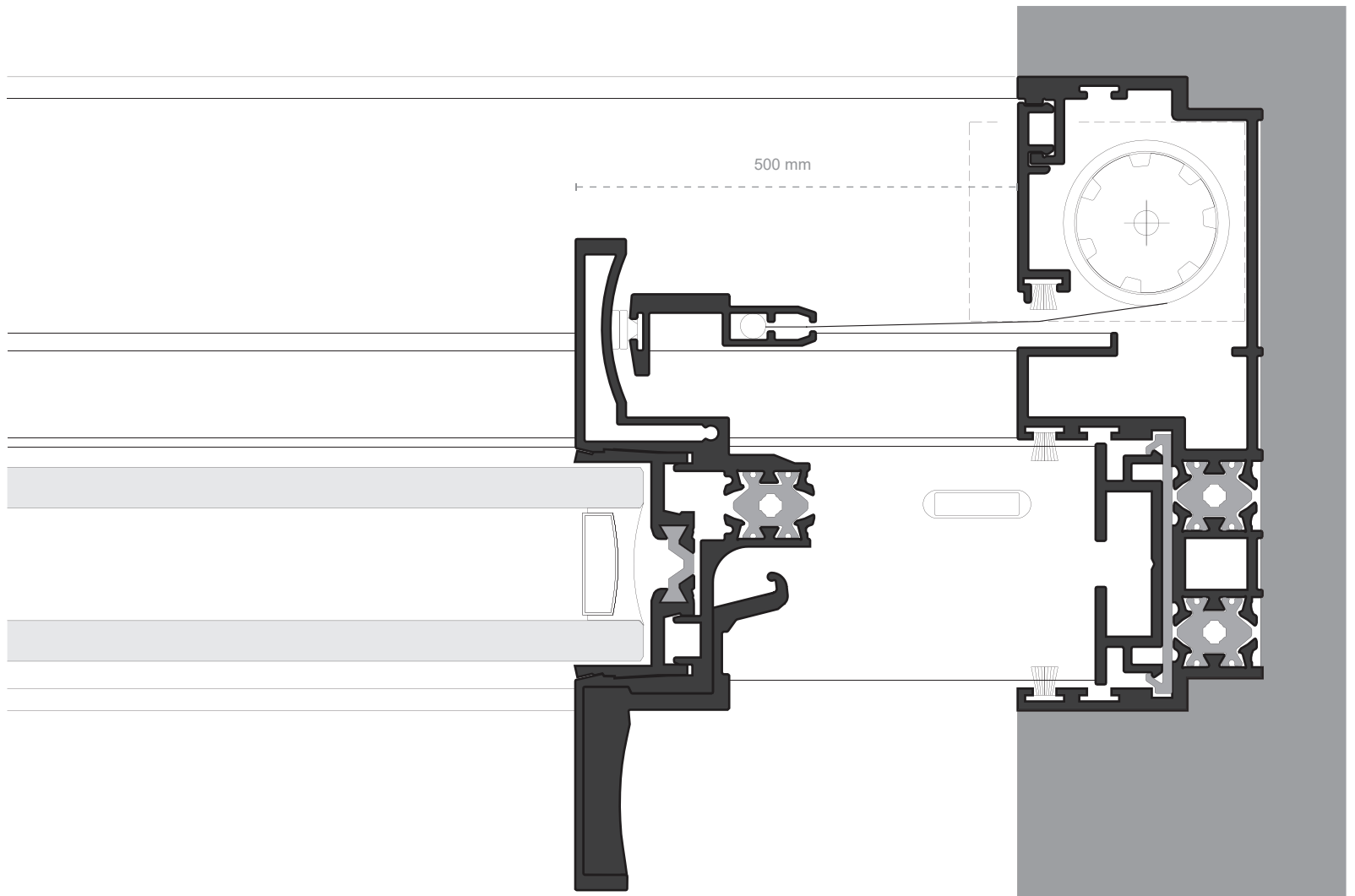

# OTIIMA'S SPECIAL SOLUTIONS

- 
- 
- 

sloped and curved glass

Luminous and playful solutions can be achieved by OTIIMA's sloped and curved glasses.

•  
•  
•  
Challenge us!



# NEW!

**OTIIMA**  
**innovation**

**INDUSTRIAL  
DOOR**





**lateral  
motorization**

---

no need for extra  
reserved space

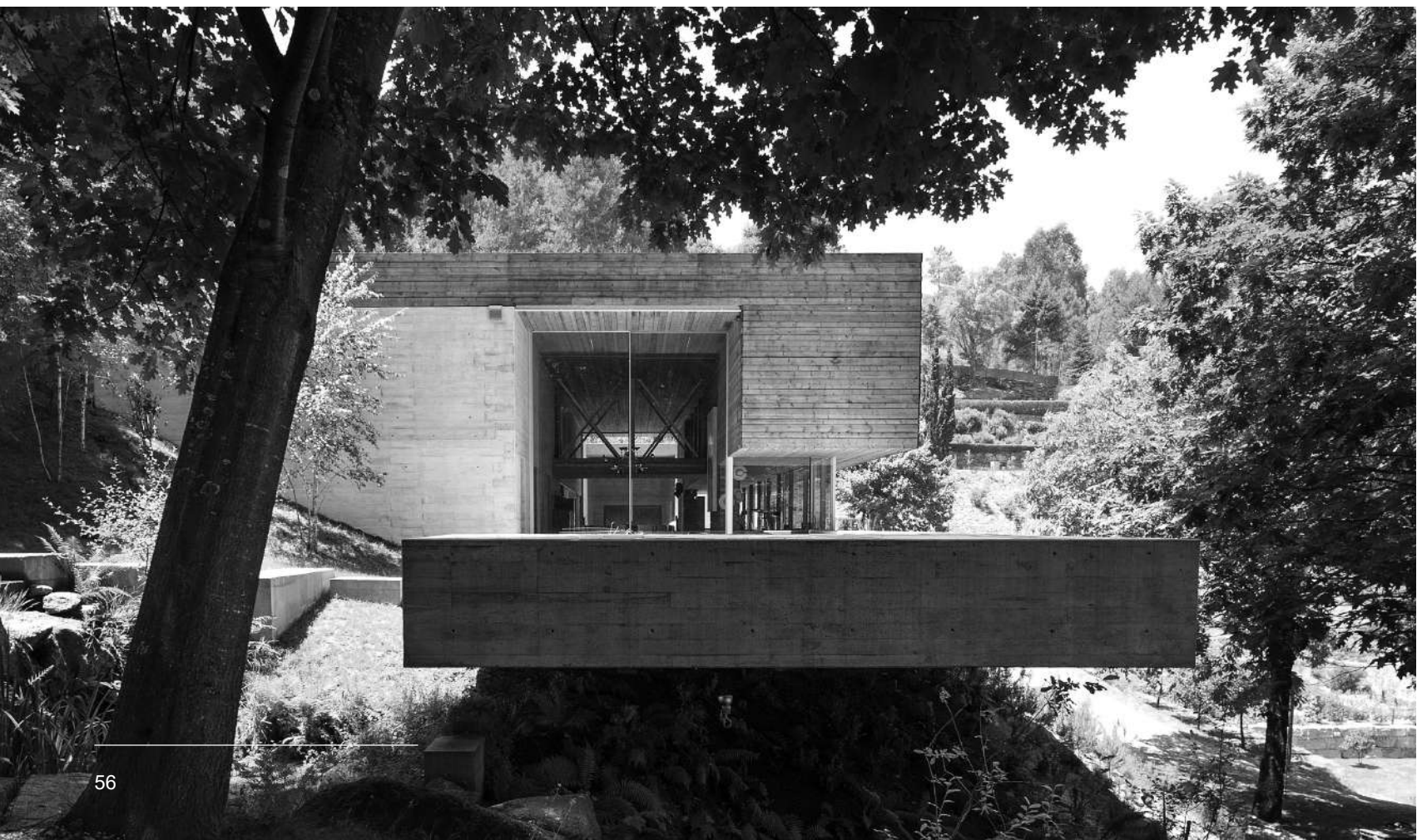



ECOSTEEL is the owning and founding company of OTIIMA | Much more than a window and an internationally renowned group with a leading position in the construction and metalwork's industry, both national and internationally.

Based in the Oporto region with two production plants of 17.500m<sup>2</sup>, ECOSTEEL group stands out for the value and solutions offered to a wide range of activities, such as development of minimal window systems, innovative construction systems, artistic installations, design and technology.

Since its establishment in 2013, the group has been managed by José Maria Ferreira, an entrepreneur with a professional path of more than 30 years.

This company is a clear case of success that has experienced a unique growth rate, passing from 30 employees to the current workforce of 250 collaborators and several international partners. With presence over the five continents and an investment of more than 15M€ in only 5 years, ECOSTEEL achieved a solid benchmark position thanks to its clustering strategy that brings together research, technology, industry and customized solutions.

ECOSTEEL is recognized for its audacity, visionary approach and for the establishment of synergies and partnerships, that are reflected on the group of the following associated companies:

**AMIITO-TECH** | [www.amiito-tech.com](http://www.amiito-tech.com)

Multidisciplinary project and development team dedicated to façade systems. The company stands for its strong technical and innovative abilities.

**ARTWORKS** | [www.artworks.pt](http://www.artworks.pt)

Non-profit association that develops and produces works of art, artistic projects and exhibitions, with a collaborative and experimental attitude.

**BIGOSSES** | [www.bigosses.pt](http://www.bigosses.pt)

Restaurant headed by the Chef José Guimarães with personalized everyday meals that reinforce well-being, health and feed the soul.

**GOFRIDAY** | [www.gofriday.eu](http://www.gofriday.eu)

Company dedicated to the production of modular floating houses. GOFRIDAY is associated with nautical activities, delivering a new concept of leisure and water living.



ECOSTEEL

**INCONS | [www.incons.pt](http://www.incons.pt)**

Construction company dedicated to new buildings and real state rehabilitation, that offers a wide range of specialized services linking innovation and technology.

**OTIIMA CUSTOM | [www.otiimacustom.pt](http://www.otiimacustom.pt)**

Company dedicated to the restoration and upkeep of antique and classic cars. This project has an internal formative component and concern in the education of young people.

**PORTWIN | [www.portwin.pt](http://www.portwin.pt)**

Company dedicated to the commercialization and assembly of high-quality framing systems in PVC, aluminium and wood, with a classical design expression.

**SIXINCH | [www.sixinch.eu](http://www.sixinch.eu)**

Entity dedicated to the design and production of high-density foam pieces, by means of an innovative coating process.

**THAT PLACE | [www.thatplace.pt](http://www.thatplace.pt)**

Company responsible for the creation and manufacturing of constructive solutions produced in composite materials such as fibre and resins.

## OTIIMA'S OWNER

- 
- 
- 

much more than a company



Much  
more  
than a  
window.

**OTIIMA**

**AUSTRALIA**

australia@muchmorethanawindow.com

**BELGIUM**

belgium@muchmorethanawindow.com

**BRAZIL**

brasil@muchmorethanawindow.com

**CANADA**

canada@muchmorethanawindow.com

**CROATIA**

croatia@muchmorethanawindow.com

**FRANCE**

france@muchmorethanawindow.com

**GERMANY**

germany@muchmorethanawindow.com

**GREECE**

greece@muchmorethanawindow.com

**INDIA**

india@muchmorethanawindow.com

**ISRAEL**

israel@muchmorethanawindow.com

**ITALY**

italy@muchmorethanawindow.com

**MOROCCO**

morocco@muchmorethanawindow.com

**OMAN**

oman@muchmorethanawindow.com

**PHILIPPINES**

philippines@muchmorethanawindow.com

**PORTUGAL**

portugal@muchmorethanawindow.com

**RUSSIA**

russia@muchmorethanawindow.com

**SINGAPORE**

singapore@muchmorethanawindow.com

**SPAIN**

spain@muchmorethanawindow.com

**SWITZERLAND**

switzerland@muchmorethanawindow.com

**TURKEY**

turkey@muchmorethanawindow.com

**UNITED ARAB EMIRATES**

unitedarabemirates@muchmorethanawindow.com

**UNITED KINGDOM**

uk@muchmorethanawindow.com

**UNITED STATES OF AMERICA**

usa@muchmorethanawindow.com



# OTIIMA'S PARTNERS

•  
•  
•

around the world

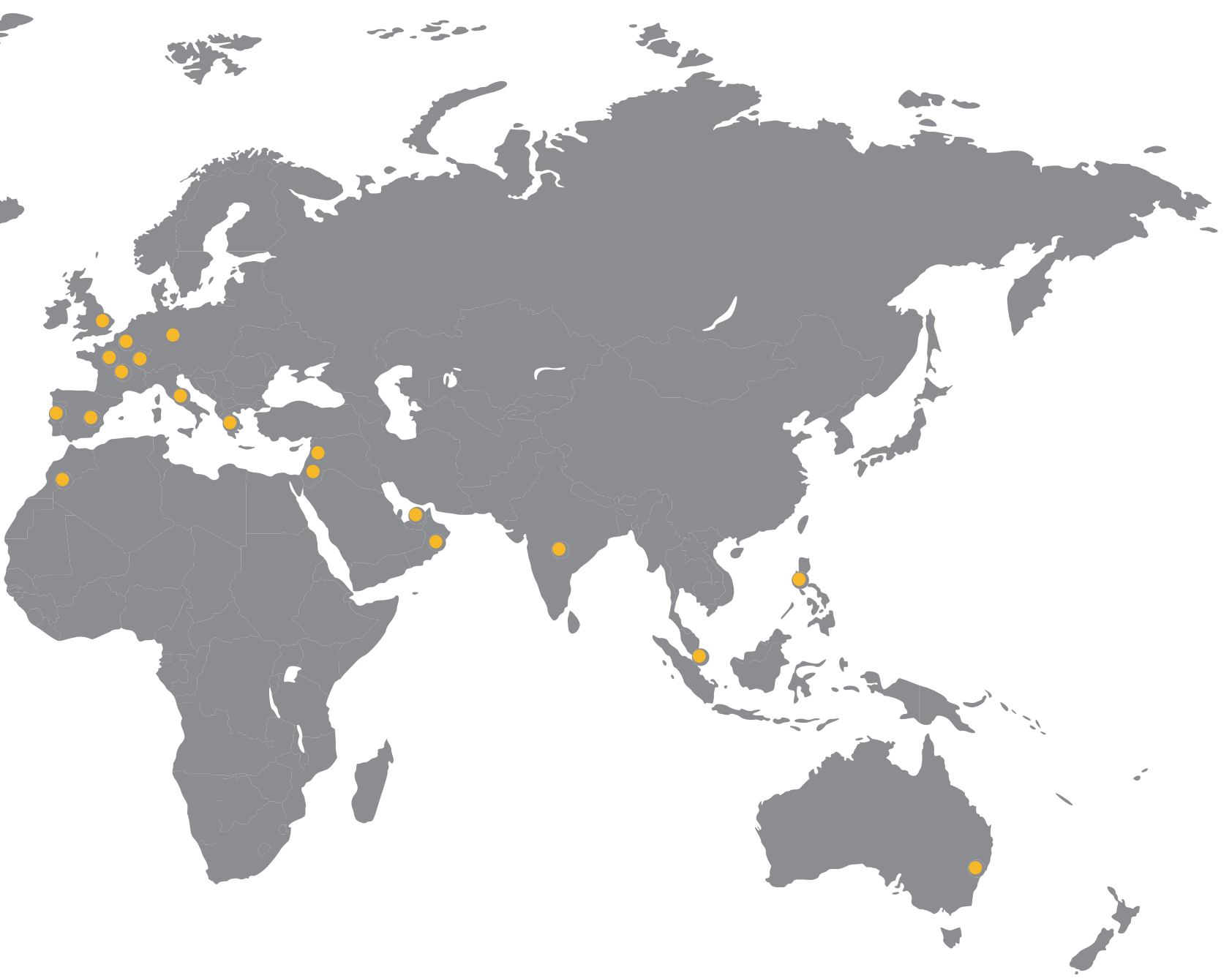

## **OTIIMA HEADQUARTERS**

ECOSTEEL group  
Parque Industrial de Laúndos, lote 40  
4570-311 Laúndos - Portugal  
T. +351 252 219 952

[info@muchmorethanawindow.com](mailto:info@muchmorethanawindow.com)  
[www.muchmorethanawindow.com](http://www.muchmorethanawindow.com)

**OTIIMA**  
**When less is perfection.**